

Installation

E19-310DC

Combination Drench Shower and Eyewash

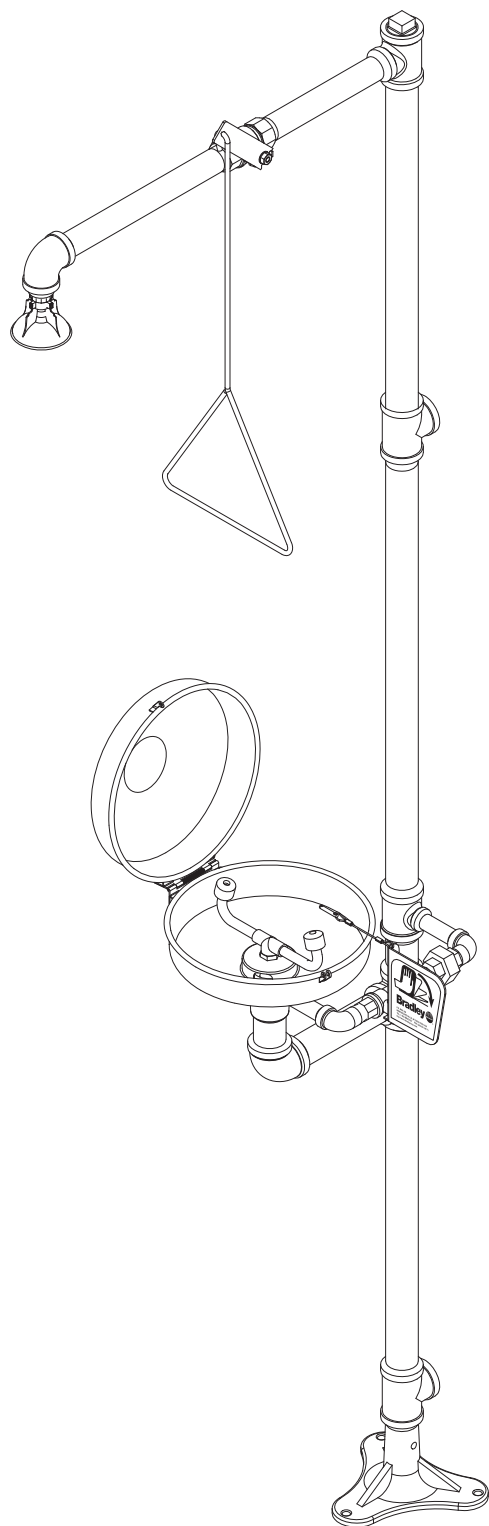
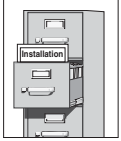

Table of Contents

Pre-Installation Information	2
Installation Instructions	3
Assembly of Components	4
Parts List	5

 **IMPORTANT** 



Read this installation manual completely to ensure proper installation, then file it with the owner or maintenance department. Compliance and conformity to drain requirements and other local codes and ordinances is the responsibility of the installer.



Separate parts from packaging and make sure all parts are accounted for before discarding any packaging material. If any parts are missing, do not begin installation until you obtain the missing parts.



Flush the water supply lines before beginning installation and after installation is complete. Test the unit for leaks and adequate water flow. Main water supply to the eyewash should be "ON" at all times. Provisions shall be made to prevent unauthorized shutoff.



The ANSI Z358.1 standard requires an uninterrupted supply of flushing fluid at a minimum 0.21 MPa (30 PSI) flowing pressure. Flushing fluid should be tepid per ANSI Z358.1.



The inspection and testing results of this equipment should be recorded weekly to verify proper operation. This equipment should be inspected annually to ensure compliance with ANSI Z358.1.



Workers who may come in contact with potentially hazardous materials should be trained regarding the placement and proper operation of emergency equipment per ANSI Z358.1.



For questions regarding the operation or installation of this product, visit www.bradleycorp.com or call 1-800-BRADLEY.

Product warranties and parts information may also be found under "Products" on our web site at www.bradleycorp.com.

Installation

Supplies Required:

- (3) M10 floor anchors and bolts
- Teflon tape and pipe sealant
- Piping to 1-1/4" BSP water supply inlet and 1-1/4" BSP drain outlet on unit
- Adequate supply pipe supports
- Minimum 102mm (4") drain to accommodate 115 liters (30 gallons) per minute discharge for shower waste
- OPTIONAL: sign-mounting hardware

NOTE: Local codes may require the installation of a backflow prevention valve to complete proper installation. Compliance with local codes is the responsibility of the installer. Valve must be tested annually to verify that it is functioning properly. Backflow prevention valves are not included with the fixture and may be supplied by the contractor or purchased from Bradley Corporation.

Step 1: Secure base to floor

1. Install three suitable anchors (supplied by installer) for M10 bolts in the floor.
2. Bolt the base to the floor anchors using M10 bolts (supplied by installer).

Step 2: Assemble components

1. Assemble the remaining unit components as shown on page 4.
 - Apply pipe sealant (by installer) to all male-threaded pipe joints.
 - Use the rubber grip pad provided or a strap wrench around pipes when tightening to prevent marring. Place the grip pad on the pipe, then put the wrench over the grip pad and turn the pipe with the wrench.
 - Bottom edge of the showerhead should be 2159mm (7'-1") from the floor.

Step 3: Connect water supply

IMPORTANT: Do not rely on Bradley's Combination Unit to support supply piping.

1. Connect water supply piping to 1-1/4" BSP inlet on unit (piping by installer). Provide adequate supports (by installer) for supply pipe using pipe hangers or other means.
2. Connect drain piping to 1-1/4" BSP drain outlet on unit (piping by installer).
3. Hang the safety sign from the unit with the curtain hooks provided (or mount it to the wall using sign-mounting hardware by installer).

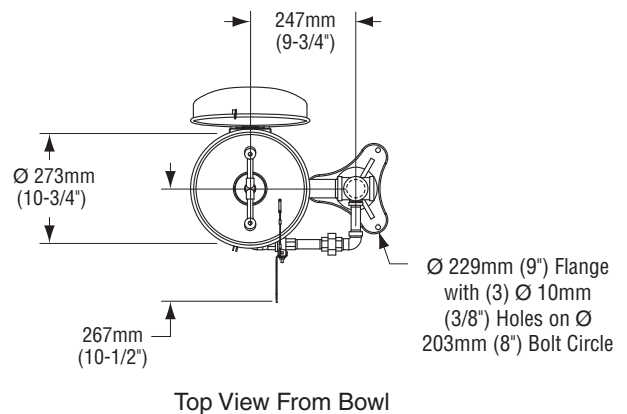
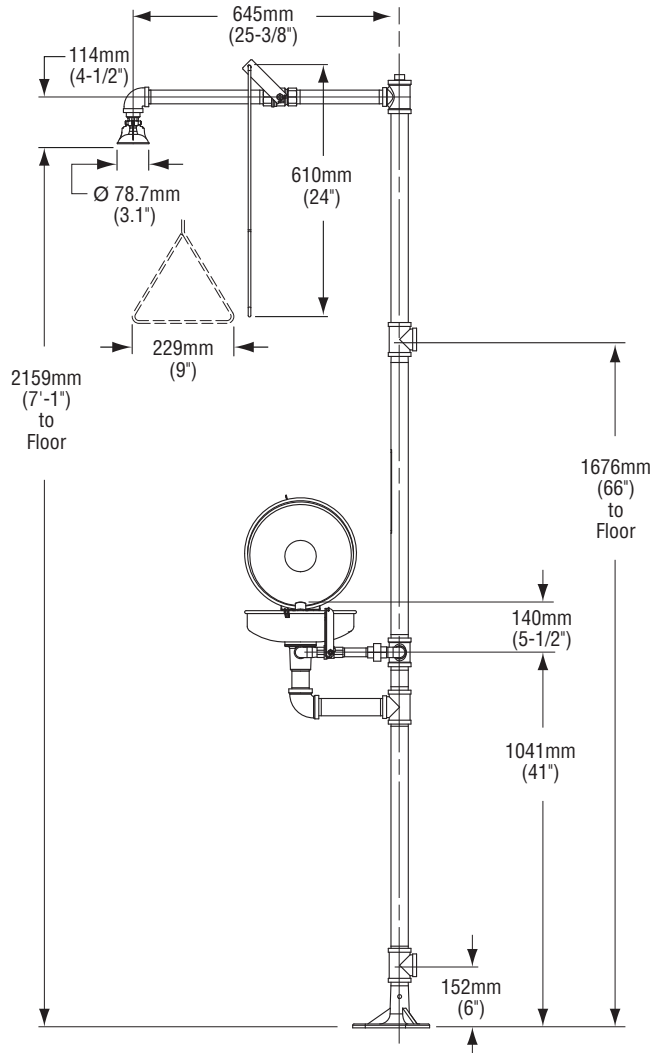

NOTE: All dimensions assume standard thread engagement. Variations in manufacturing allow for +/- 3mm (1/8") per threaded joint. To find the tolerance of a dimension, add the number of thread joints in between a dimension and multiply it by 3mm (1/8").

Assembly of Components

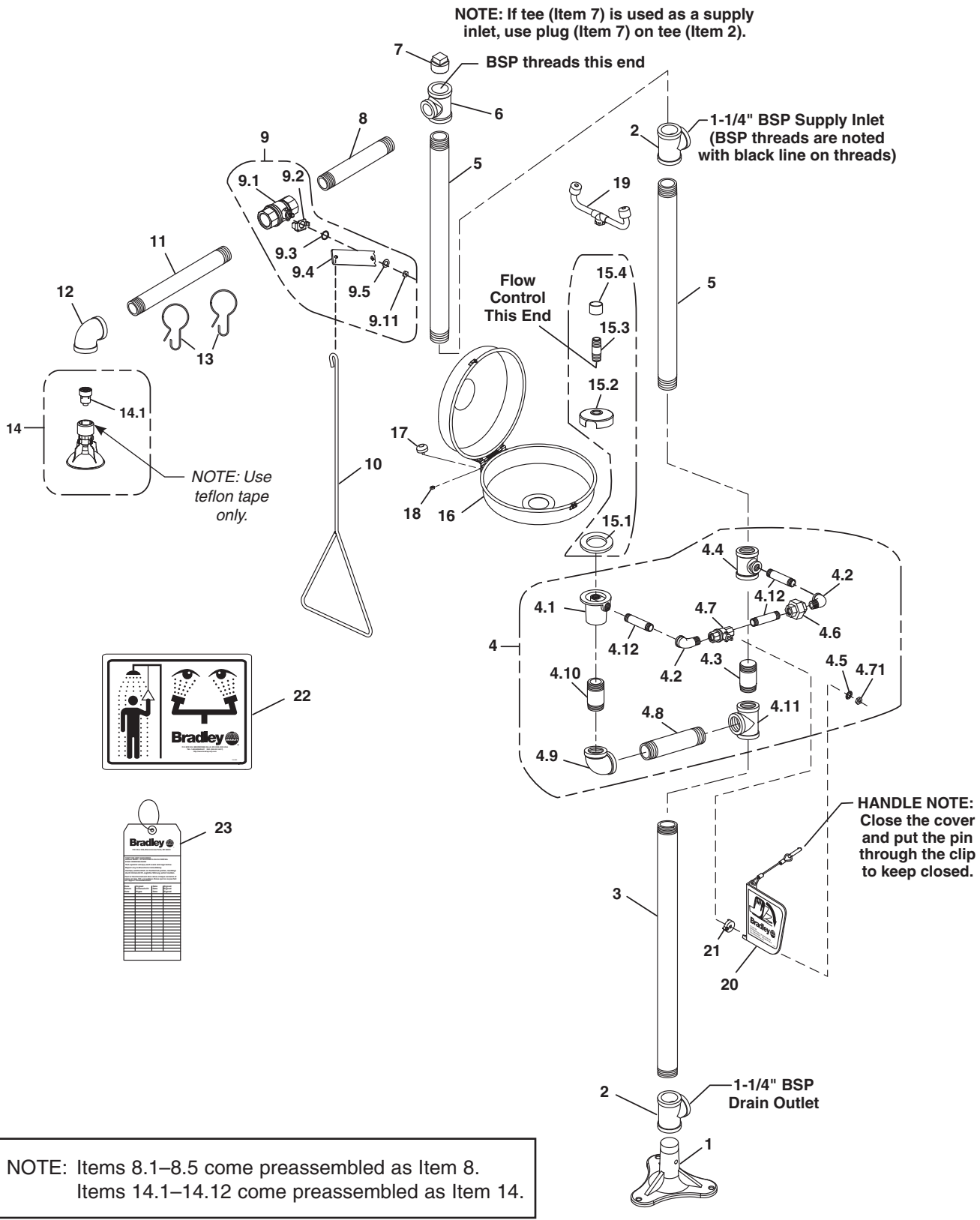

NOTE: Items 8.1–8.5 come preassembled as Item 8.
Items 14.1–14.12 come preassembled as Item 14.

Parts List

Item	Part No.	Qty	Description	Item	Part No.	Qty	Description
1	131-059	1	Base	9.2	140-720	1	Stop Bracket
2	169-727B	2	Pipe Tee 1-1/4" NPT	9.3	124-048	1	Washer, Friction
3	113-006LC	1	Pipe 1-1/4" NPT x 706 mm	9.4	128-129	1	Handle
4	S39-226	1	Europe Eyewash Sub-Assy.	9.5	142-002DC	1	Lockwasher
4.1	111-039	1	Inlet Drain Fitting	10	128-156A	1	Pull Rod - 24" Long
4.2	169-025	2	Street Elbow 1/2" NPT	11	113-006LK	1	Pipe 1" NPT x 310 mm
4.3	S06-136	1	Plgd. Nipple 1-1/4" NPT x 76mm	12	169-847	1	90° Elbow 1" NPT
4.4	169-841	1	Reducing Tee	13	151-001	2	Curtain Hook
4.5	142-002DA	1	Lockwasher	14	S24-188	1	Plastic Showerhead Assembly
4.6	169-726	1	Union 1/2" Female NPT	14.1	S24-187	1	Flow Control Assembly, 23 GPM
4.7	S27-282	1	1/2" Ball Valve with Nut	15	S45-1782	1	Cup Strainer Prepack
4.71	110-215	1	Jam Nut only	15.1	124-028	1	Center Seal Gasket
4.8	113-006QX	1	Pipe 1-1/4" NPT x 180mm	15.2	173-009	1	Cup Strainer
4.9	169-764	1	90° Pipe Elbow 1-1/4" NPT	15.3	S21-071	1	Stem Pipe Assembly
4.10	113-006LE	1	Pipe Nipple 1-1/4" NPT x 76mm	15.4	113-1159	1	Spacer, Drain
4.11	169-727	1	Plpe Tee 1-1/4" NPT	16	S90-009	1	Dust Cover Assembly
4.12	113-006LQ	3	Pipe 1/2" NPT x 76mm	17	269-447	1	Bumper
5	113-006LW	2	Pipe 1-1/4" NPT x 579 mm	18	161-025	1	Nut
6	169-722B	1	Reducing Tee	19	S05-091	1	Eyewash Yoke
7	169-724	1	Pipe Plug 1-1/4" NPT	20	S08-056	1	Handle Assembly
8	113-006LL	1	Pipe 1" NPT x 234 mm	21	153-372R	1	Adapter
9	S30-059	1	Stay-Open Ball Valve Assy. 1" NPT	22	204-421	1	Emergency Tag
9.1	S27-278	1	1" Ball Valve with Jam Nut	23	114-052E	1	Safety Sign
9.11	110-214	1	Jam Nut only	24	269-915	1	Grip Pad (not shown)

Prepack S30-087 includes Items 4.71, 4.5, 20