

### Model #2 – Wall hung with wing bracket

Generally recommended for Urinal Screen application. Screen is mounted to wall with Mills chrome plated wing bracket.

### Model #3 – Floor mounted

Generally recommended for Privacy Screen application. Screen has floor mounting and requires minimum 3" concrete floor for anchoring. This model can also be modified to become a floor-to-ceiling mounted by changing the mounting pilaster.

### Model #4 – Wall hung with T-335L Brackets

Generally used for Urinal Screen application where the use of the Mills wing bracket is not desired.

### Model #5 – Government flanged with Wing Bracket

Generally used where specifications require the Urinal Screen to have a continuous bracket in addition to the Mills wing bracket.

## Construction

### Permaseal™ Panels

Consist of two sheet metal faces spaced and insulated with a moisture-resistant honeycomb core, adhered to the inner surfaces with a 10155-2 moisture-resistant adhesive and set under pressure for 24 hours. Edges are formed to interlock together to provide a watertight fit without loose crown molding. Corners are welded and finished smooth. Panels are minimum 1" thick, unless otherwise indicated. Continuous panel and wall angles shall be single piece for all wall and pilaster connections. Baked Enamel Panels are manufactured from domestic 22 gauge galvanized sheet metal.

Baked Enamel panels are cleaned, primed and finished with automatically applied electrostatic high-grade synthetic enamel, and oven-baked to provide a mar-resistant finish. Mills offers a full range of standard colors.

Stainless Steel Panels are manufactured from 22 gauge 300 Series stainless steel. Options for finish include #4 satin brushed, 5WL textured, or leather grain finish. Includes cover with self-adhesive protective coating for protection during installation.

### Hardware

Compartments shall be provided with all hardware and fastenings to provide a complete installation.

### Urinal Screens

Urinal Screens feature same construction as panels; minimum 1" thick. Three styles: Wall-Hung, which attach to wall with two chromed non-ferrous brackets; Floor-Mounted, which provide 5" width front attached with four brackets, two at the wall and two at the front; and GSA, which attach to wall with 8" top-mounted 11 gauge steel chrome-plated wing bracket and continuous full-height "U" bracket.

### Model #2

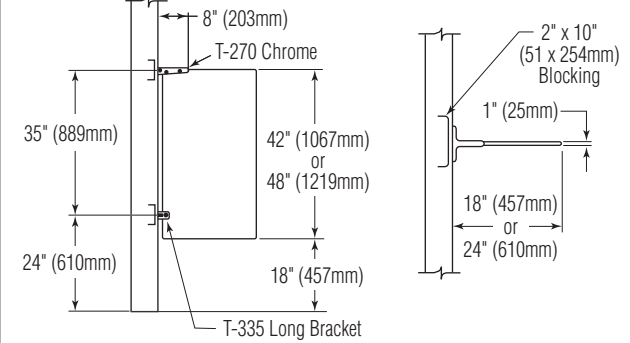

### Model #3

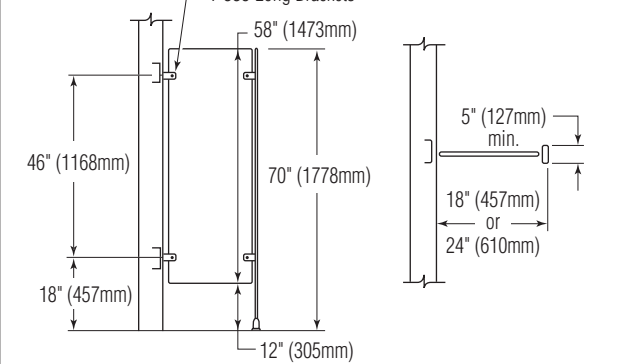

### Model #4

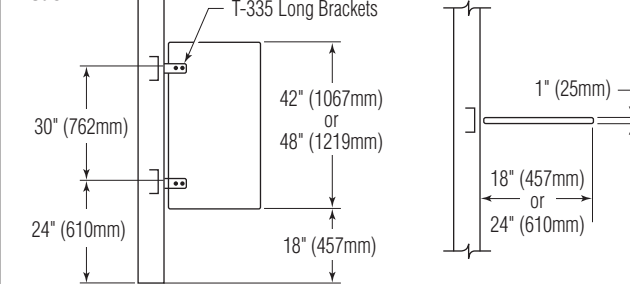

### Model #5

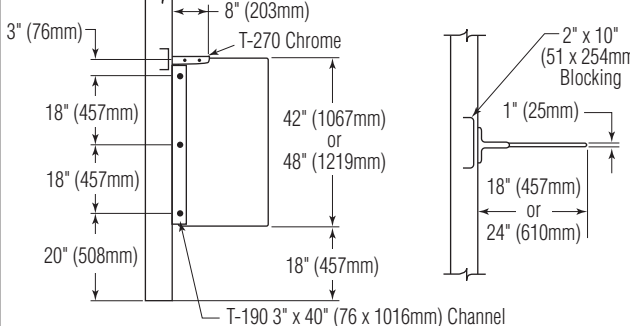

Verify all rough-in dimensions prior to installation.

Consult local and national codes. Conformity and compliance to local and national codes is the responsibility of the installer.

**Sample Specification****Part 1 – General**

## 1.1 Summary

This section includes (edit to suit project requirements):

- A. Baked Enamel or Stainless Steel toilet partitions, urinal screens, shower stalls, dressing compartments, hardware and structural accessories.

## 1.2 Related Sections

- A. Section 10800: Toilet and Bath Accessories

## 1.3 Submittals

- A. Shop drawings: Layout of toilet partitions, urinal screens and shower stalls.
- B. Product data: Manufacturer's catalog cuts of typical panel, pilaster, door, hardware and fastening.
- C. Color chips: Manufacturer's complete range of 18 standard colors for baked enamel.
- D. Finishes: 300 Series stainless steel #4 finish with options for textured finishes.

## 1.4 Quality Assurance

- A. Components of toilet partitions shall be sourced from one single-source manufacturer who certifies that materials meet or exceed specifications.
- B. Installation: Installer shall have a history of completed jobs of similar size and scope, and shall be qualified.

## 1.5 Delivery, Storage and Handling

- A. Pre-finished materials shall be delivered to the job site in original, unopened cartons or other packaging materials necessary to protect finishes. Packages shall be clearly labeled with manufacturer's name and item description. Materials shall be stored in such packaging until installation. Partitions shall be stored in vertical position with adequate support to ensure flatness and to prevent damage to pre-finished surfaces.

## 1.6 Project Conditions

- A. Building shall be enclosed and provide complete protection from outside weather. Temperature within building shall be above a minimum of 6°F.

## 1.7 Warranty

- A. Manufacturer shall provide a 15-year warranty against rusting of panels from the inside.
- B. Manufacturer shall provide a 5-year warranty for all chrome hardware, and a lifetime warranty for stainless steel hardware.

**Part 2 – Products**

## 2.1 Manufacturer

- A. Privacy and urinal screens, hardware and supporting brackets manufactured by The Mills Company, Willoughby, OH.

## 2.2 Equipment

- A. Privacy and urinal Screens.

## 2.3 Components

- A. Panels: Permaseal panels shall be formed to interlock together to provide a watertight fit which will not permit liquid penetration. Permaseal panels shall be formed as a two-piece unit and shall not utilize any loose crown molding. Permaseal panel corners are to be brazed and finished smooth.
  - 1. Baked Enamel Permaseal Panels: 1" thick shall be manufactured from domestic 22 gauge galvanized steel, spaced and insulated with a moisture-resistant honeycomb core, adhered to the inner surfaces with a moisture-resistant adhesive and set under pressure for 24 hours.

- 2. Stainless Steel Permaseal Panels: 1" thick shall be manufactured from 22 gauge 300 Series stainless steel #4 finish, spaced and insulated with a honeycomb core, adhered to the inner surfaces with a moisture-resistant adhesive and set under pressure for 24 hours.

- 3. Alternate: Continuous panel and wall angles shall be single piece, for all wall and pilaster connections.

- B. Pilasters (Fronts): 1¼" thick fronts shall be constructed as per Permaseal™ panels and doors with interlock design.

- 1. Privacy and Urinal Screens: Wall Hung, Floor Braced and GSA, have 1" thick panels of the same construction as Permaseal™ panels. Wall Hung Urinal screens shall attach to wall with two chromed nonferrous panel brackets. Optional 8" top-mounted 11 gauge steel chrome-plated wing bracket available. Floor-mounted screen with 5" width front attached with four brackets: two at wall and two at front. GSA provided with wing bracket and continuous full-height "U" wall bracket.

- C. Hardware: Compartments shall be provided with all hardware and fastenings to provide a completed installation.

- 1. Fittings: All brackets shall be nonferrous heavy-duty chrome-plated or stainless steel. Fasteners for hinges, slide latch and keeper to be chrome-plated or stainless steel theft-proof.

## 2.4 Finishes

- A. Baked enamel partitions shall be cleaned and finished with an automatically applied electrostatic high-grade synthetic enamel and oven-baked to provide a mar-resistant finish.
- B. Stainless steel partitions shall be covered with self-adhesive protective coating for protection from scratches during installation.

**Part 3 – Execution**

## 3.1 Inspection

- A. Before installation, the installer shall inspect the site to ensure that no defects or conditions exist which would result in an unsatisfactory installation of the partitions. Measurements should also be taken at this time to further ensure correct installation.

## 3.2 Installation

- A. Install screens in accordance with shop drawings and manufacturer's current installation instructions. Leave partitions complete, clean and free from defects in workmanship. Self-adhesive protective plastic shall be removed from all stainless partitions.
- B. Doors and hardware shall be thoroughly adjusted, lubricated and left in proper working condition. Set doors in open or closed position as shown on drawings.
- C. Outswing doors of more than 105° must have a wall or panel to stop door travel. (Note: Failure to follow manufacturer's recommended installation procedures voids warranty.)

## 3.3 Cleaning

- A. All rubbish and cartons generated by installing contractor shall be removed and area left broom clean.

Verify all rough-in dimensions prior to installation.

Consult local and national codes. Conformity and compliance to local and national codes is the responsibility of the installer.