

Installation Instructions

S53-303

**Aerada 90-80 Series
Wristblade Faucet**



WARNING

Installations may be performed at different times of construction by different individuals. For this reason, this manual should be left on-site with the facility or maintenance manager.

Read this entire installation manual to ensure proper installation, then file these instructions with the owner or maintenance department.

Flush all the water supply lines before making connections, then make sure the water supply is turned off before beginning installation.

Pressurized plumbing fixtures must be installed in accordance with manufacturer's recommendations. The supply piping to these devices must be securely anchored to the building structure to prevent the installed device from unnecessary movement when operated by the user. Use extreme caution when installing the device to prevent damage to the exposed significant surface.

Compliance and conformity to local codes and ordinances is the responsibility of the installer.

Product warranties may be found under "Product Information" on our web site at www.bradleycorp.com.

Table of Contents

Faucet Components	2
Supplies Required for Installation	2
Faucet Installation	3
Quarter-Turn Cartridge Installation	3

Components for Aerada 90-80 Series Faucet (4" centerset)

Carefully separate all parts from packaging and check each part with the illustrations below. Make sure all parts are accounted for before discarding any packaging material. If any parts are missing, do not attempt to install your Bradley Faucet until you obtain the missing parts.

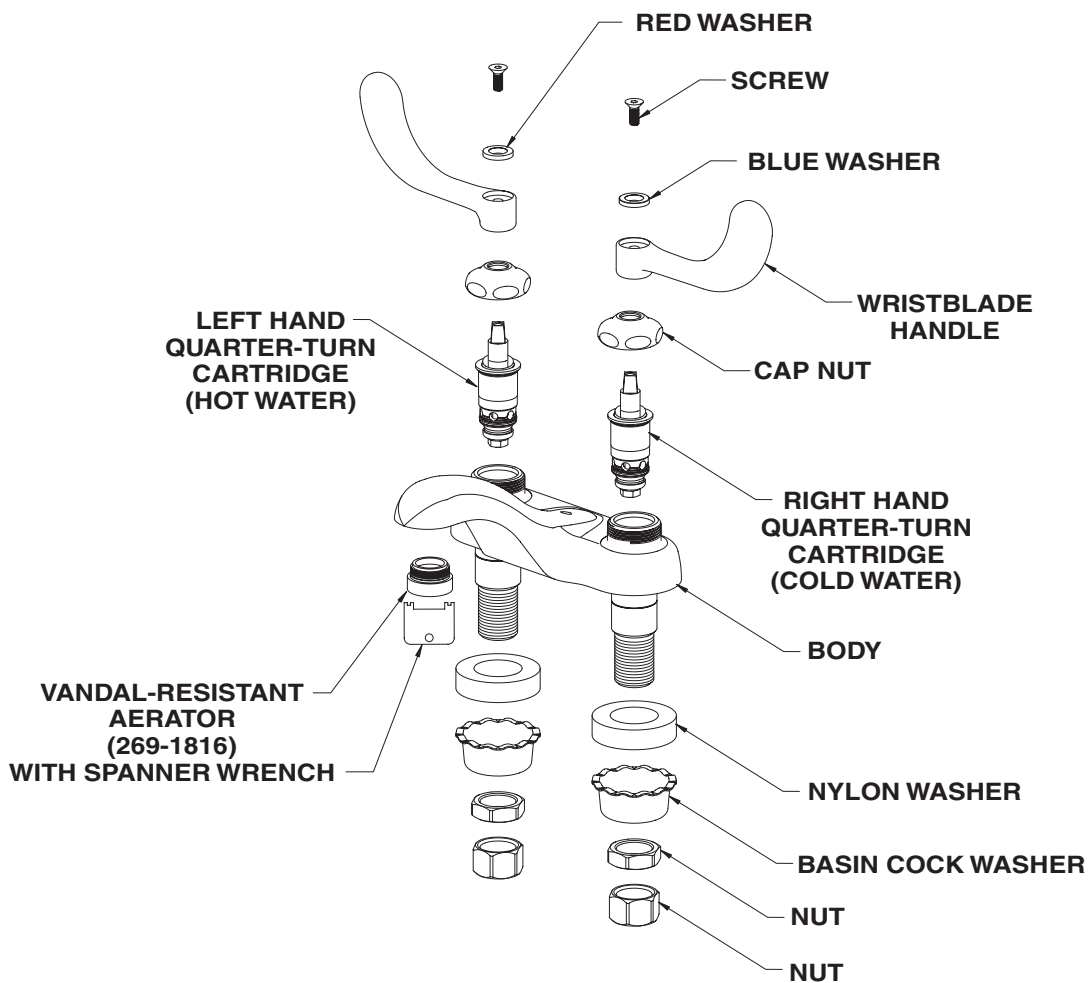

Supplies Required for Installation:

- Teflon Tape
- 1/2" NPT water inlet supply
- Pipe fittings

Faucet Installation

1. Apply putty or a rubber washer to the underside of the faucet body to ensure a good seal and level installation.
2. Place the faucet body shanks through the holes in the deck and secure the faucet to the deck with the mounting hardware supplied.
3. Connect the water supply lines.

NOTE: For installation of the quarter-turn cartridges, refer to the instructions below.

4. After cartridge installation is complete, remove the aerator and flush the water supply lines (for approximately one minute) to remove any debris that may have accumulated during installation.

Quarter-Turn Cartridge Installation

NOTE: Always place a new cartridge in the closed position when installing into the valve body.

NOTE: Cartridges are stamped "LH" to designate left hand and "RH" to designate right hand.

RIGHT HAND CARTRIDGE

1. Insert the cartridge into the valve body and push until it "seats."
2. Attach the cap nut and tighten hand-tight. Attach the handle.
3. Holding the handle in the "closed" position, fully tighten the cap nut to 15–25 FT. LB. torque.

LEFT HAND CARTRIDGE

1. Insert the cartridge into the valve body and push until it "seats."
2. Attach the cap nut and tighten hand-tight. Attach the handle.
3. Holding the handle in the "open" position, fully tighten the cap nut to 15–25 FT. LB. torque.
4. Return the handle to the "closed position" and check handle alignment. Adjust if necessary.

