

Installation

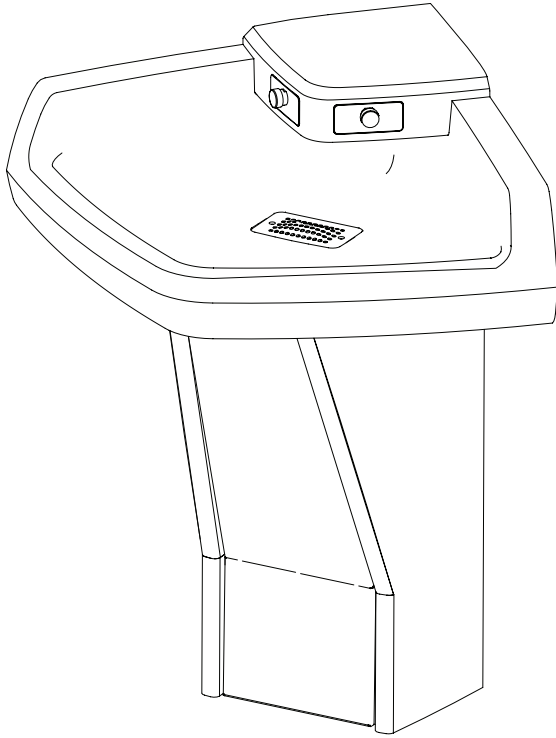

MF2902/AST4

Terrazzo Corner-Fount™ Washfountain

(Standard*, Juvenile and OBC Height)

* Standard Height is ADA Compliant



Table of Contents

Washfountain Components	2
Rough-in Instructions	3
Installation Instructions	3-7
Maintenance and Troubleshooting	7-10

IMPORTANT!

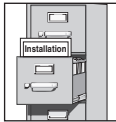

Read through this installation manual to ensure proper installation. When finished with the installation, file this manual with the owner or maintenance department. Compliance and conformity to local codes and ordinances is the responsibility of the installer.



Separate parts from packaging and make sure all parts are accounted for before discarding any packaging material. If any parts are missing, do not begin installation until you obtain the missing parts.

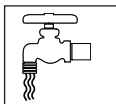

Water supply requires a flowing pressure of between 20 psi and 80 psi. Make sure that all water supply lines have been flushed and then completely turned off before beginning installation. Debris in supply lines can cause valves to malfunction.



Terrazzo solid surface material care and maintenance information may be found in the "Products" section on our web site at www.bradleycorp.com. Select Technical Data document #9901.



Product warranties may be found in the "Products" section on our web site at www.bradleycorp.com.

Supplies Required:

- (2) 3/8" diameter bolts with washers and (2) floor anchors appropriate for your installation
- 1/2" nominal copper tubing for hot and cold water supply lines
- 1-1/2" NPT drain trap and waste connection
- Pipe sealant and plumber's putty



Parts included with the Corner-Fount

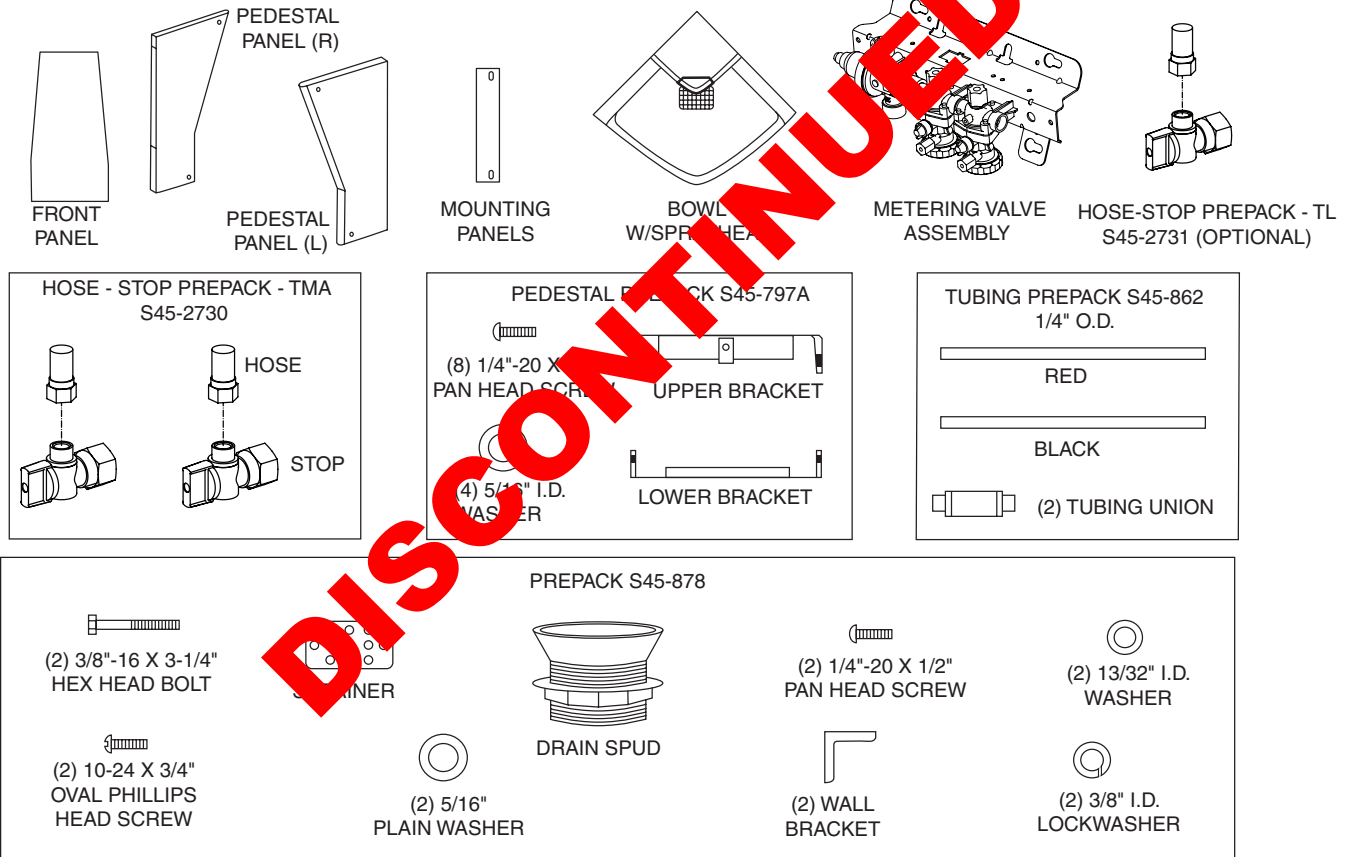

1 Rough-in Piping and Install Wall Anchors

(mm)

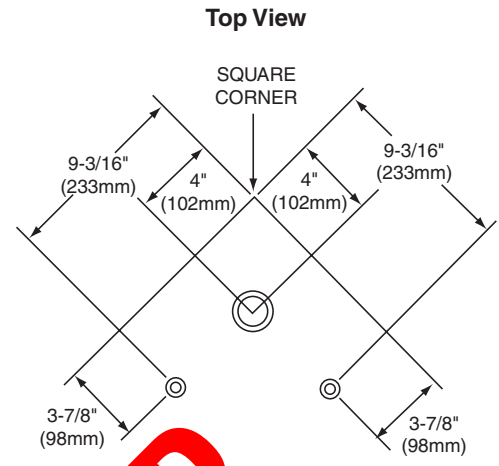
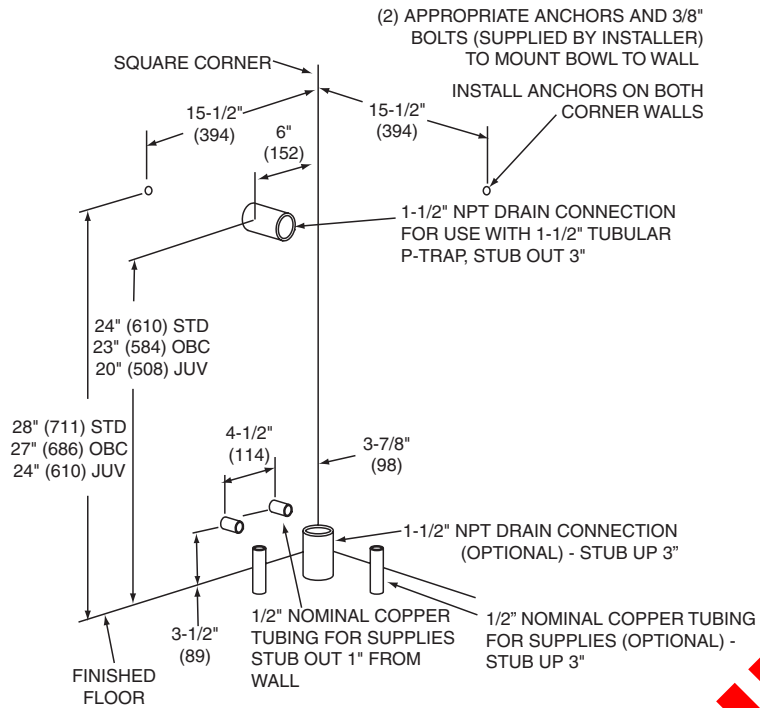

Wall anchors need to withstand 1000 lb. pull force.

Drain and supply rough-ins may be installed on either wall.

2 Assemble Pedestal

A Fasten the mounting panels to the pedestal with four pan head 1/4"-20 x 1/2" screws supplied.

B Install the upper and lower brackets to the pedestal panels with two pan head 1/4"-20 x 1/2" screws and 5/16" I.D. washers supplied.

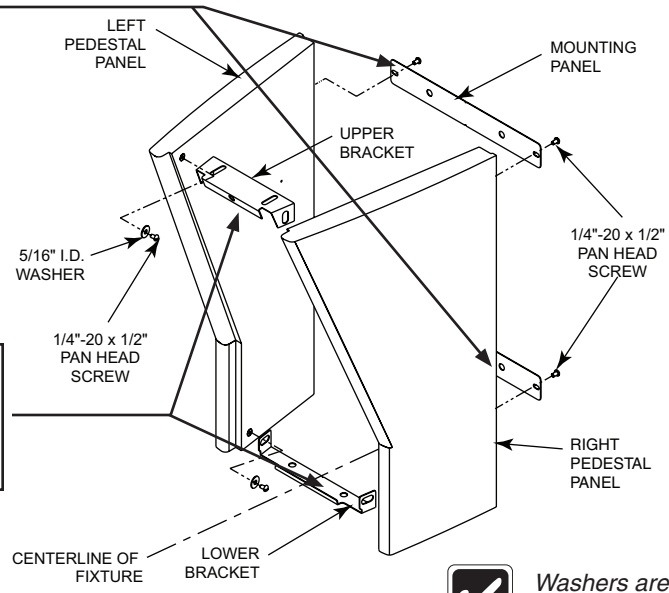

Washers are not utilized on back of mounting panels.

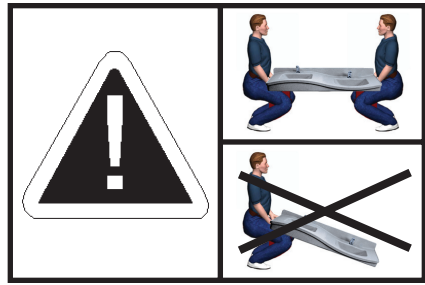

3 Install Pedestal, Wall and Floor Anchors



Before mounting the pedestal to the floor, make sure the floor is level. If necessary, install shims under the left and/or right pedestal. Remove molding strips or tiles that could prevent a flush mounting to the wall.

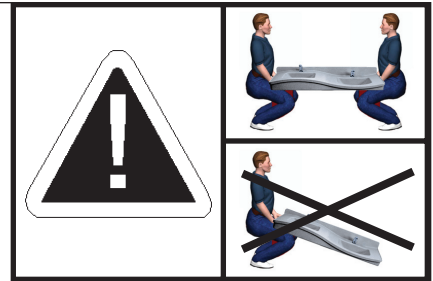

A Measure and mark the centerline of the wash fountain on the wall and floor. Align the locating notches on the mounting panel with the centerline.

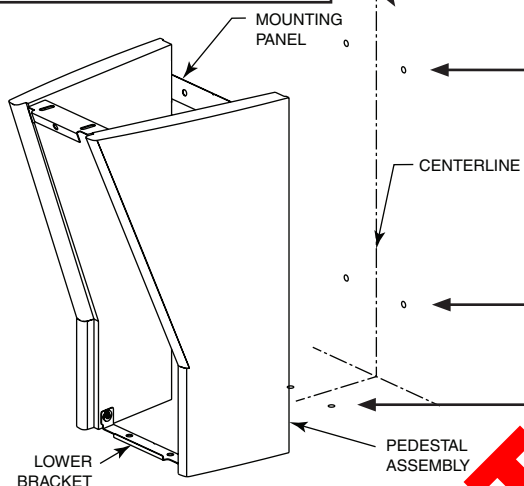

B Secure the pedestal assembly to the wall and floor anchors using 3/8" bolts and washers (supplied by installer).

C With assistance, carefully lift the bowl into the pedestal frame using appropriate lifting procedures. Ensure the bowl remains 3 – 4 inches from the wall.



Do not leave the bowl on the pedestal unsupported, as it may fall and cause personal injury or damage to property.

4 Attach Bowl Brackets and Connect Sprayhead Tubing

DISCONTINUED

A Install the two wall anchor brackets to the back of the bowl using the 3/8"-16 x 3-1/4" hex head bolts, 13/32" I.D. plain washers, anchor plates, 3/8" I.D. lockwashers and 3/8-16 hex nuts provided.

Back view

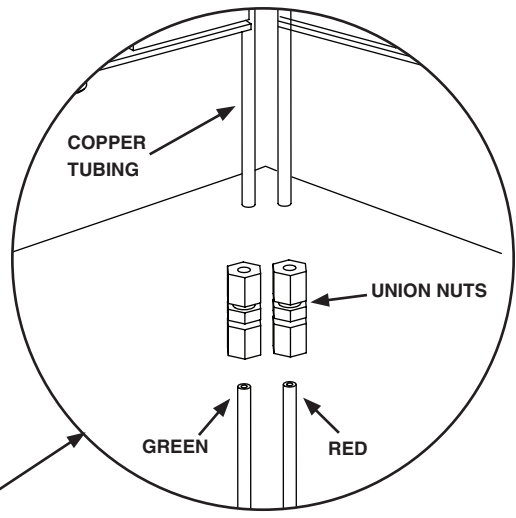
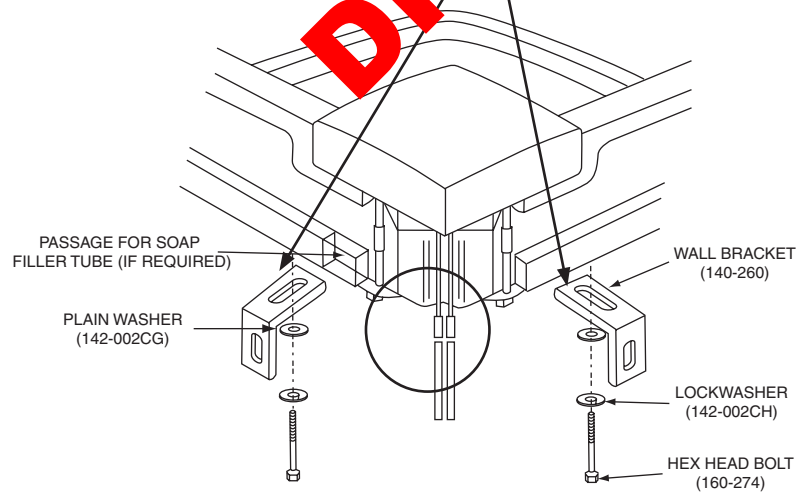

B Attach the two colored plastic tubing unions to the copper sprayhead inlet tubes. Tighten union nuts finger-tight plus two wrench turns. When facing the rear of the bowl, the color sequence is (L-R) green; red.

5 Attach Bowl to Pedestal and Wall

A Uncoil the infrared sensor leads from the rear of the backsplash.

B Slide the bowl back to the wall and secure the bowl's wall brackets to the wall anchors with the two 3/8" bolts and washers (supplied by installer).

C Fasten the bowl to the upper bracket on the pedestal assembly with the two 1/4"-20 x 1/2" pan head screws and 5/16" I.D. washers (see Figure 6).

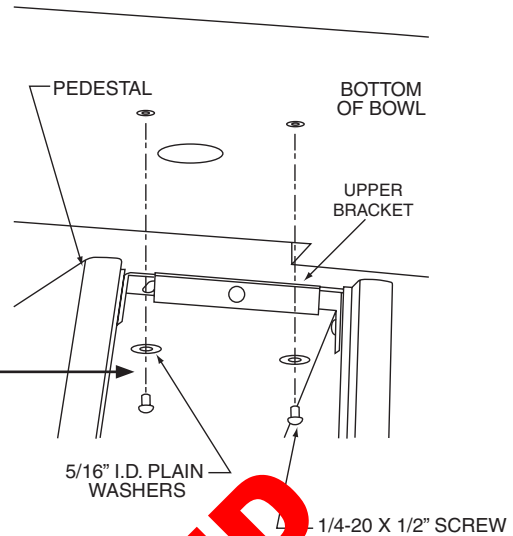

6 Metering Valve and Sprayhead Supply Connections

Warning: While it does not matter which valves go to which push buttons, it is important not to cross-connect the supply tubes.

A Insert 1/4" tubing from the sprayhead aerators to the couplings on the air valves.

Green 1/4" Supply Tube Red 1/4" Supply Tube

Navigator®
TMV

B Insert the 1/8" tubing from the pushbuttons to the connectors on the air valves.

Green 1/8" Air Tube

Red 1/8" Air Tube

C Connect the hot and cold supply lines to the corresponding inlets. Turn on water and check for leaks.

7 Install Valve Assembly and Supply Connections



The letter "H" on the Navigator Mixing Valve indicates hot water supply inlet.

C

Mount the valve assembly bracket as shown onto the left side of the pedestal using the two supplied 1/2-20 X 1/2" screws. Do not overtighten.

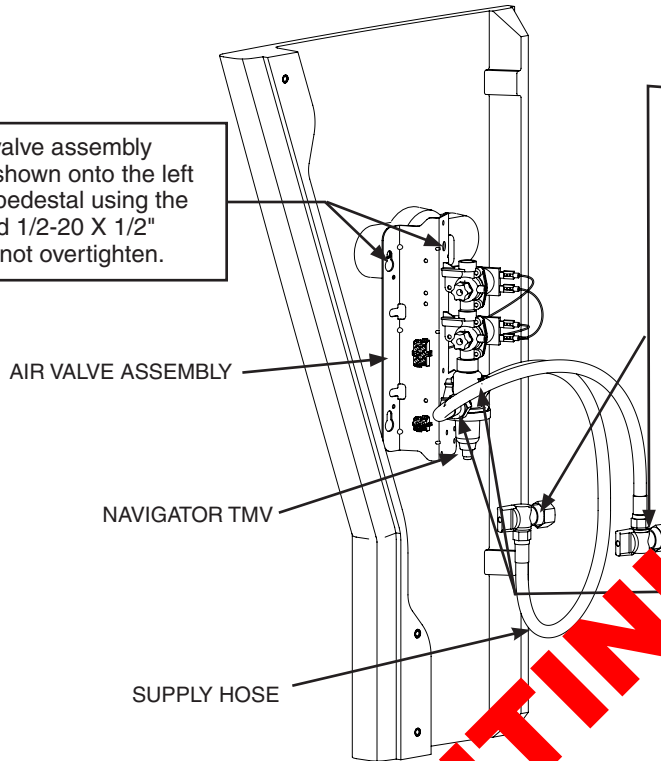

A

Attach the stops to the hot and cold water rough-ins. Connect one end of each supply hose to the stops.



FOR OPTIONAL SINGLE TEMPERED SUPPLY: Attach the stop valve to the 1/2" tempered supply line. Connect the stop valve to the air valve assembly with the flexible supply hose.

B

Connect the other end of each supply hose to the Navigator TMV valve assembly (one on the hot side, one on the cold side).

8 Drain Assembly



Install drain spud per common industry standard. (Discard rubber gasket included with drain spud; it cannot be used in this application.)



Install the **optional soap system** following the instructions outlined in manual 215-1136 provided with the soap system.

Drain Assembly

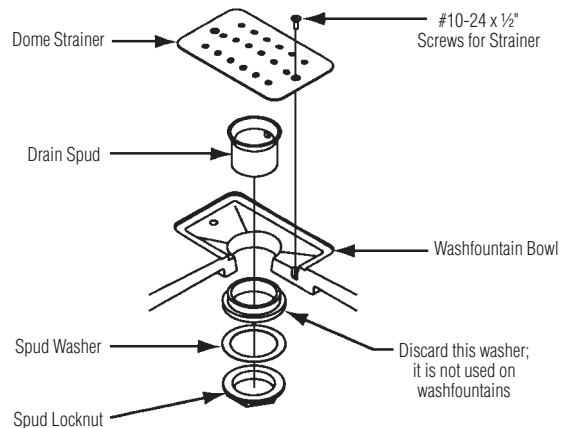

DISCONTINUED

9 Check Operation

A Check to make sure both stops are fully open (see step 7).

B Turn on the main water supply and check for leaking.

C Operate push buttons until air is purged from the lines.

This valve is **NOT** factory preset. Upon installation, the temperature of this valve must be checked and adjusted to ensure delivery of a safe water temperature. Water in excess of 110°F (43°C) may cause scalding.

D Loosen Cap Screw about 1/4" (4-6 turns) and lift up cover (do not remove).

E Using cover, turn cartridge gently until desired water temperature is reached. Do not turn past stops as this may damage unit. Push cover down and tighten screw.

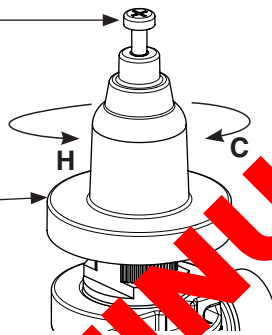
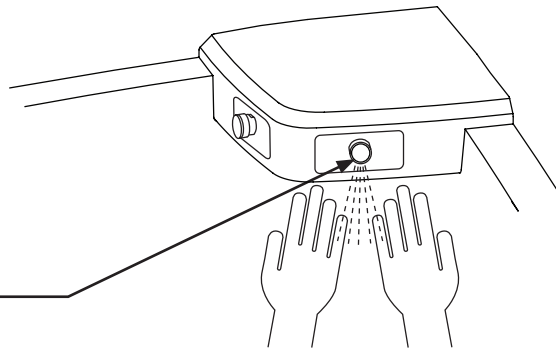

10 Completing Installation

A Securely attach Front Panel to upper and lower brackets with screw provided.

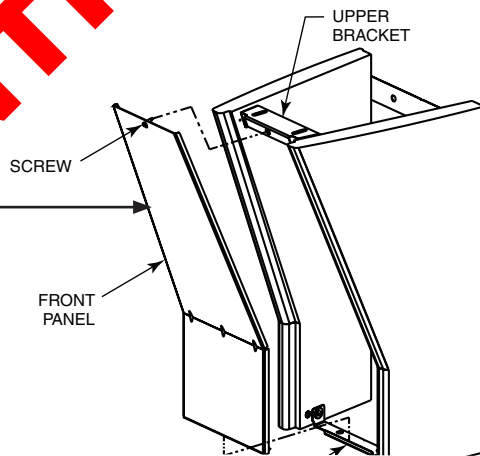

DISCONTINUED

Metering Air Valve Maintenance

The air valve timer is located next to the tube connector on the air valve body. The timer is capped with a filter to prevent dirt build-up on the timer. The air valve timing can be adjusting from 5–60 seconds.

A Remove filter cap and use a screwdriver to adjust the timer (see illustration). Turning the timer clockwise increases the time; turning the timer counter-clockwise decreases the time.

B When desired duration is reached, replace filter cap over the timer.

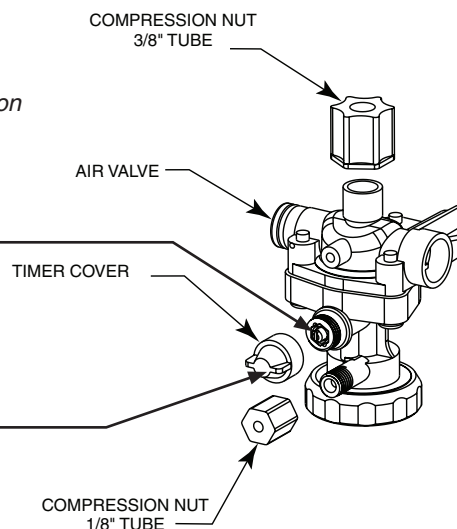

AST4 Valve Repair Kits

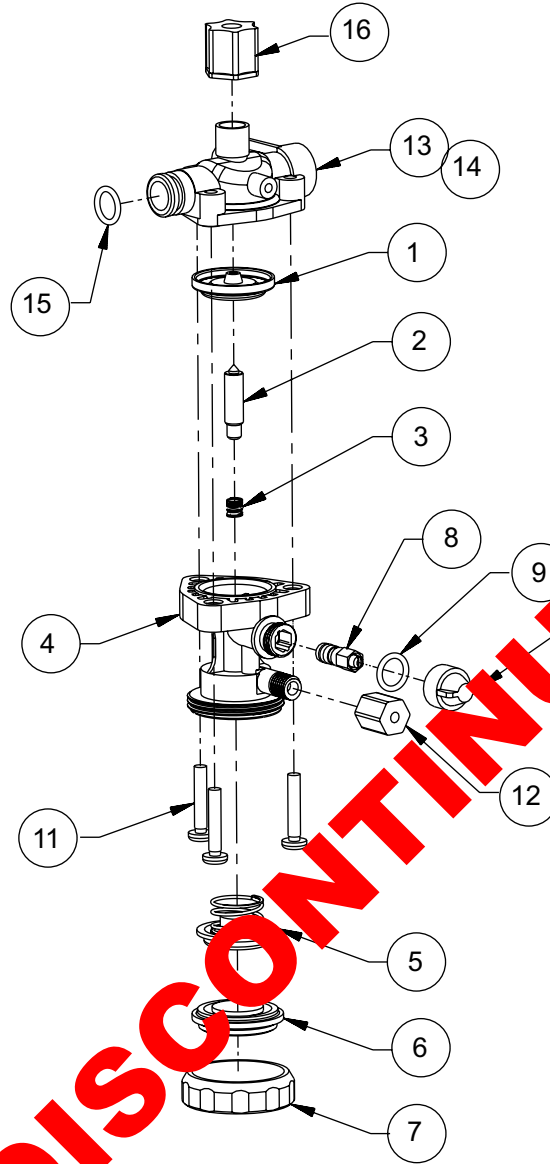

DISCONTINUED

Item	Description	AST4 Valve Kit S65-260	Repair Kit (Upper) S65-261	Repair Kit (Lower) S65-262	AST4 1/4" Tube Valve S07-078S	AST4 1/4" Tube Valve S07-078AS
		Quantity				
1	Diaphragm	1	–	1	1	1
2	Armature	1	–	1	1	1
3	Spring	1	–	1	1	1
4	AST4 Upper Body	1	–	–	1	1
5	Magnet/Diaphragm Assembly	1	1	–	1	1
6	AST4 Valve Cover	1	1	–	1	1
7	AST4 Valve Clamp Nut	1	1	–	1	1
8	AST4 Valve Timer Assembly	1	–	–	1	1
9	O-Ring #2-012	1	–	–	1	1
10	AST4 Valve Timer Cover	1	–	–	1	1
11	Screw, #8 x 7/8"	3	–	–	1	1
12	Compression Nut, 1/8" Tube	1	1	–	1	1
13	Valve Body, 1/4" Tube - Closed	–	–	–	1	–
14	Valve Body, 1/4" Tube - Thru	–	–	–	–	1
15	O-Ring	–	–	–	1	1
16	Compression Nut, 3/8" Tube	–	–	–	–	–

Troubleshooting-Metering Valve



Turn off water supplies to unit before troubleshooting.

Problem	Cause	Solution
Valve will not shut off.	<i>Timing mechanism is clogged.</i>	Clean and inspect timing mechanism: 1. If compressed air is available, blow water and debris from timer cover of timing mechanism. 2. Turn adjusting screw out all the way. Clean and inspect screw and valve body. 3. Turn adjusting screw in to desired cycle time.
Valve will not turn on.	<i>Water is not being supplied to unit.</i>	Open all stops on mixing valve.
	<i>Water pressure is over 80 PSI.</i>	Install a pressure reducing valve.
	<i>Failed diaphragm/magnet assembly.</i>	Unscrew the valve clamp out of valve. Remove valve cover. Gently press the diaphragm. The valve should activate. If not, replace the diaphragm/magnet assembly.
Timing can not be adjusted for more than 5 seconds.	<i>There is an air leak</i>	Check the valve assembly: 1. Check all tubing and fittings for proper assembly. 2. Tighten cap and nut on 1/8" tubing.
Push button does not work properly.	<i>Air volume may not be sufficient to operate valve.</i>	Check for leaks and lubricate U-cup: 1. Check all fittings for air leaks.
Water is dripping from the streamformers.	<i>Debris has accumulated on valve seat or orifices.</i>	Clean and inspect valve seat. 1. Remove screws and disassemble metering valve. 2. Clean valve seat and inspect for deep gouges or scratches. Replace valve body if necessary. 3. Remove any debris clogging off-center hole in rubber diaphragm.

DISCONTINUED

Thermostatic Mixing Valve Troubleshooting



- Before attempting to troubleshoot the valve or disassemble the components, check for the following conditions:
- If stop valves are used, make sure that they are fully open.
 - Make sure that the hot and cold inlet pipes are connected properly, and that there are no cross-connections or leaking stop valves.
 - Check the hot water heater output to make sure that it is at least 10° F above the set temperature.



Be sure to close the appropriate shut-off valves prior to disassembly of the valve and reopen the valves after inspection and repair is complete.

Problem	Cause	Solution
External leaks.	Damaged cartridge or O-rings.	Replace cartridge with part number 269-1927
Improper water temperature or temperature fluctuation.	Hot water supply is not 10° above desired set point.	Increase hot water supply temperature
	Valve temperature is not properly set.	Adjust the temperature as shown on page 7 step 9.
Limited water flow.	Dirt and debris have built up in the valve or strainer.	1. Check to make sure both hot and cold supplies are connected to the valve for mixing valve and that they have water flow. 2. Remove U-clip and U-clip. Remove the cartridge and clean the strainer. It is not required to grease cartridge, however if desired, use silicone grease only. Do not use grease on check valves.

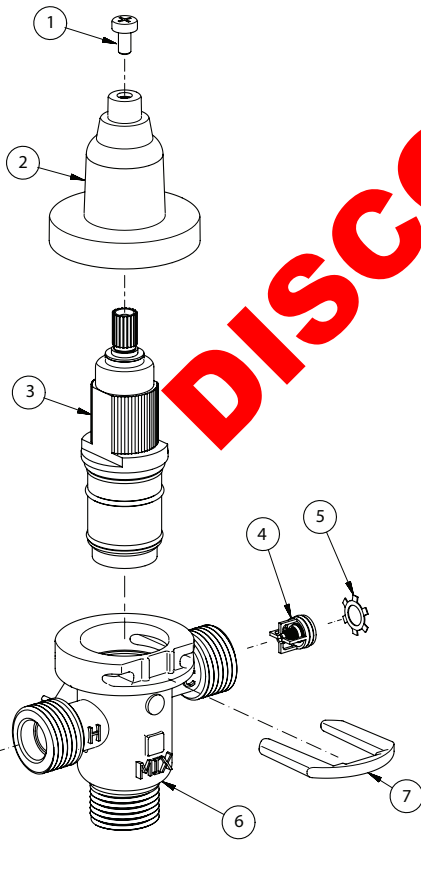

Parts List

Part No.	Description	Quantity
		S59-4000
160-463	Cap Screw	1
107-582	Cover	1
269-1927	Thermostatic Cartridge	1
198-014	Check Valve*	2
132-051	Retaining Ring*	2
118-319	Valve Body	1
146-079	U-Clip	1

* Included with Prepack S65-326

Tempered Line Adapter Option Part no. S39-804

(replaces S59-4000 if tempered line is used)

Strainer (173-028)

