

Installation

LD3060

OmniDeck™ - 3000 Series

Table of Contents

Pre-Installation information	2
Supplies Required	2
Components	3-4
Dimensions	5
Rough-Ins	6
OmniDeck Installation	7
Supplies, Drain and P-trap	8
Trap Cover Installation	8
Cleaning and Maintenance	9
Troubleshooting Veritherm™ TMV	10

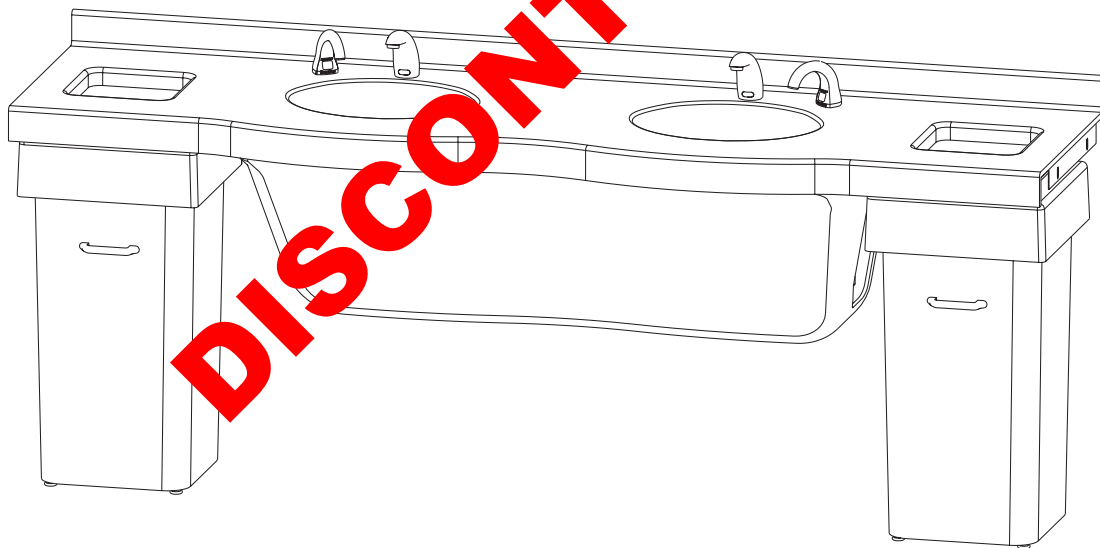

Bradley 

⚠ IMPORTANT! ⚠

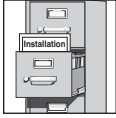

Read this entire installation manual to ensure proper installation. When finished with the installation, file this manual with the owner or maintenance department. Compliance and conformity to local codes and ordinances is the responsibility of the installer.



Separate parts from packaging and make sure all parts are accounted for before discarding any packaging material. If any parts are missing, do not begin installation until you obtain the missing parts.

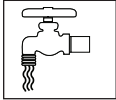

Make sure that all water supply lines have been flushed and then completely turned off before beginning installation. Debris in supply lines can cause valves to malfunction.

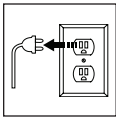

Turn OFF electrical power to the electrical outlets, then unplug all electrical units prior to installation. Electrical power MUST remain off until installation is completed. After installation is complete, turn on the water supply first, then turn on the electrical power.

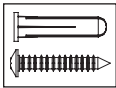

Hardware supplied by installer must be appropriate for all construction. Wall anchors used must have a minimum pull-out rating of 1,000 lbs.



Product warranties and service parts information may be found on our web site at bradleycorp.com.

Supplies Required:

- (6) 3/8" wall anchors, bolts and 1" min. O.D. washers to mount support brackets to wall (min.pull-out rating of 1,000 lbs.)
- #10 wall anchors/bolts/washers to mount angle brackets to side wall, if required (two each per bracket)
- (2) 1/4" wall anchors (to mount optional mixing valve/bracket)
- 1/2" NPT hot/cold or tempered supply piping
- 1 1/2" NPT drain piping
- 110 volt electrical outlet for optional 10/24 VAC plug-in transformer, if required

DISCONTINUED

Components

OmniDeck Configurations
(contact your Bradley Representative for part number)

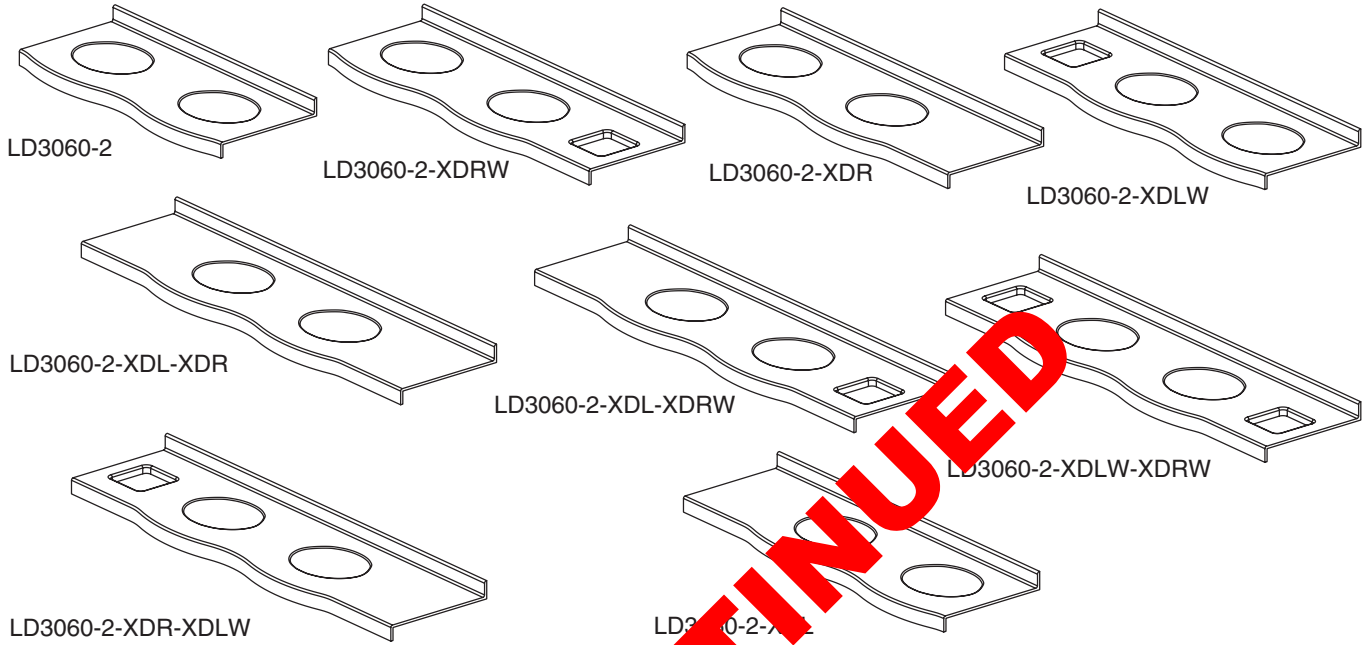

Panel Fasteners (160-132)
Finish Washers (142-002CA)



Trap Cover (textured)
Putty (186-1261)
Coal (186-1261B)

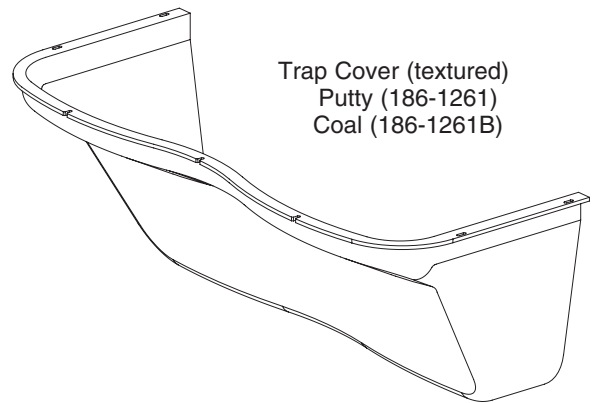

DISCONTINUED

Mounting Bracket (140-823R)

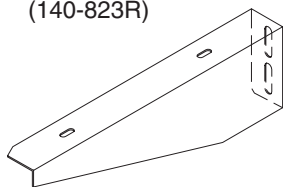

Angle Bracket (140-824)

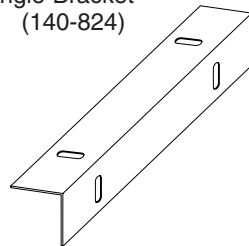

Trap Cover V2 (with soap access opening)
Putty (186-1544)
Coal (186-1544B)

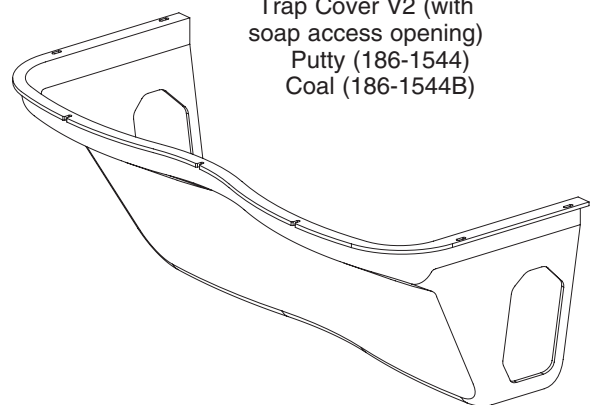

Bracket Hardware (two each required to attach bracket to OmniDeck)
Screw (160-120)
Washer (142-002AZ)



Angle Bracket Hardware (two each required to attach bracket to OmniDeck)
Screw (160-120)
Washer (142-002AZ)

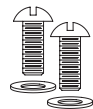

Components

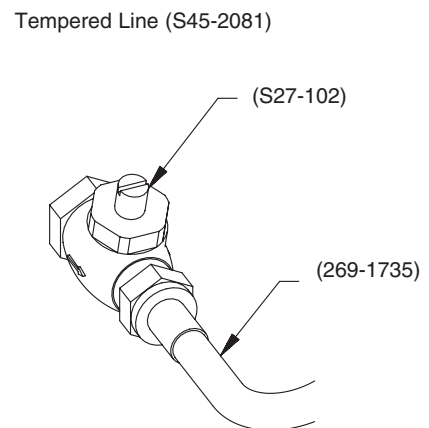
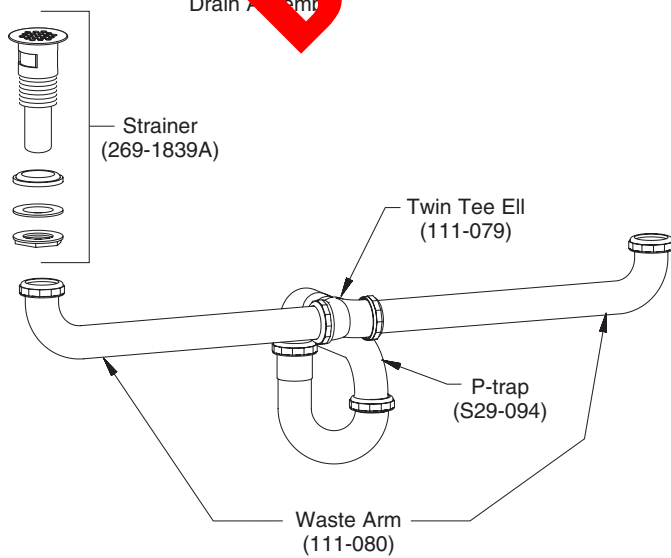
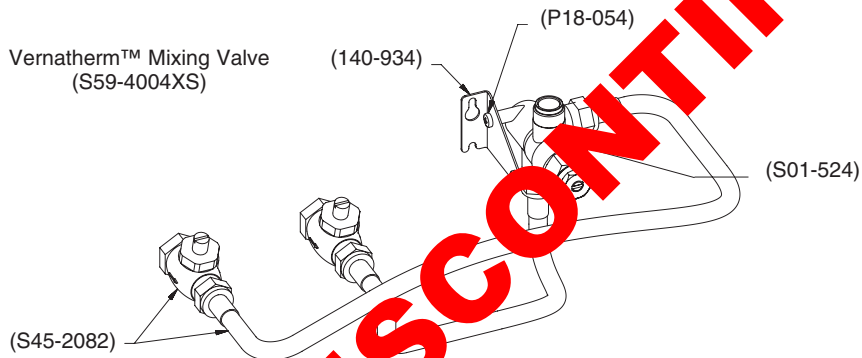
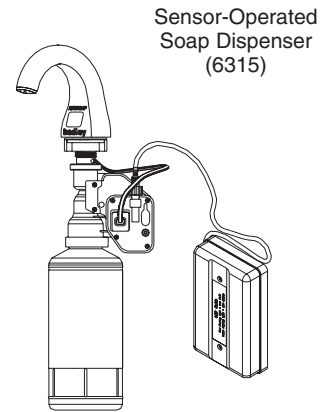
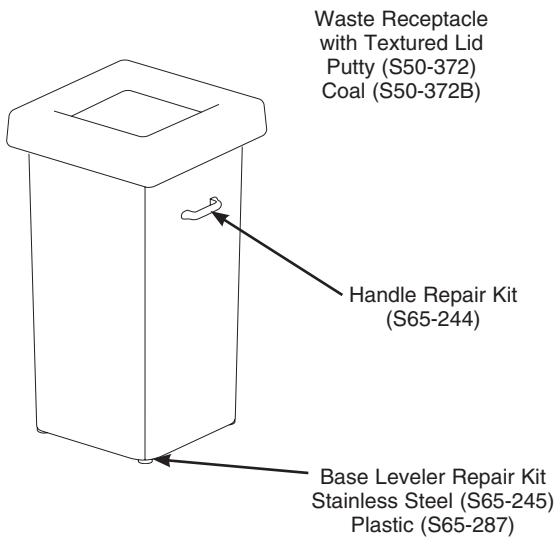

DISCONTINUED

Dimensions (shown with optional selections)

LD-3060-2 XDLW/XDRW is shown. Other configurations are similar. All dimensions shown are for reference only and are subject to change.

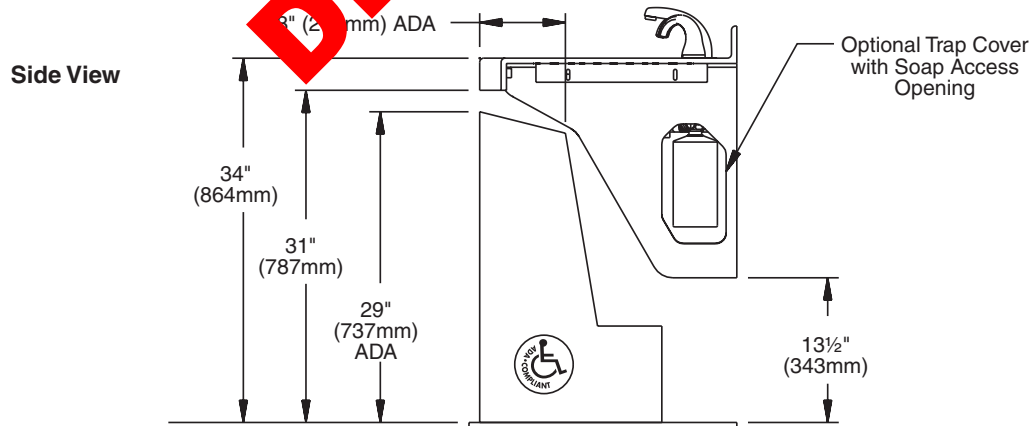
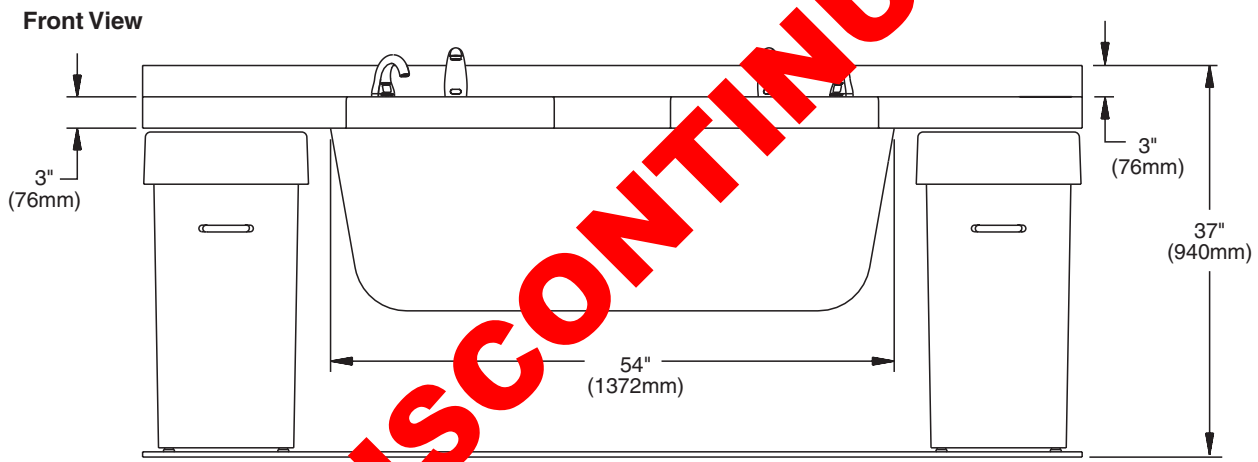
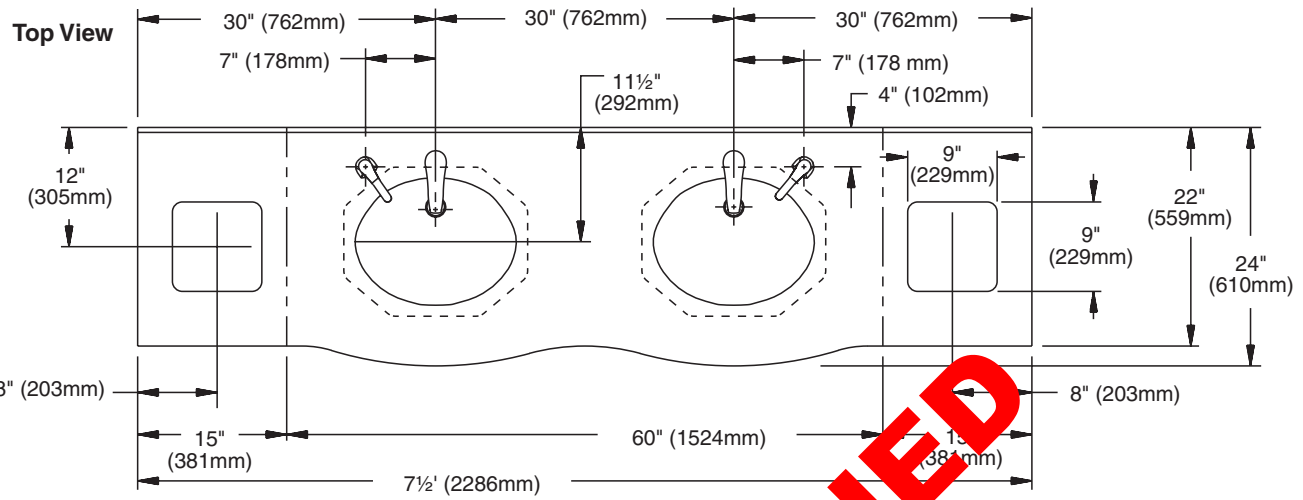

DISCONTINUED

1 Rough-Ins

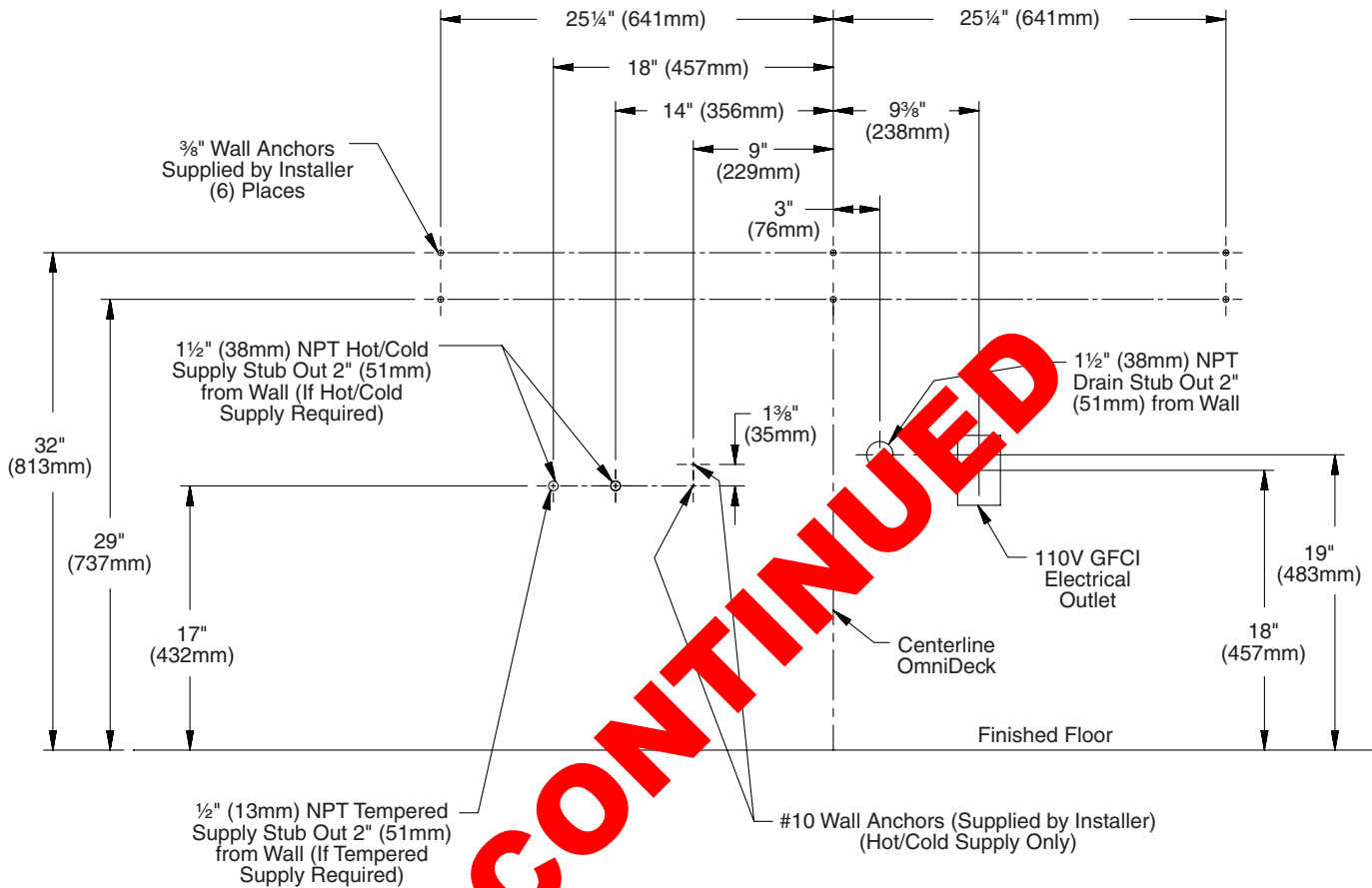
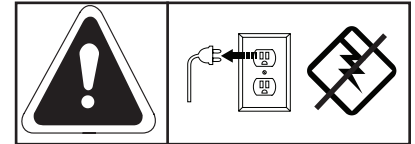

Side Wall Mounting Locations for Angle Brackets (standard height mounting)

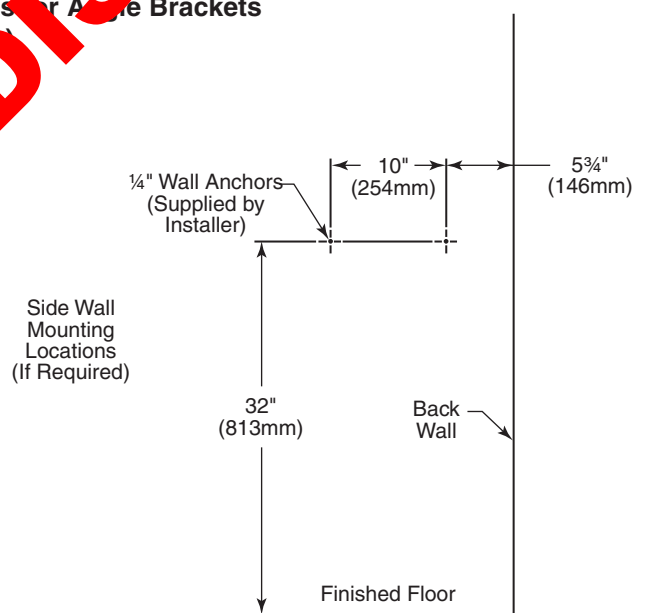

DISCONTINUED

2 OmniDeck Installation

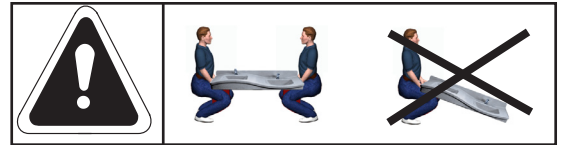

- LD-3060-2 XDLW/XDRW is shown throughout. Other configurations are similar.
- Reference mounting height dimension from the top of the OmniDeck to the finished floor is 34" (864mm) maximum (OmniDeck thickness is 1/2" [13mm]). The support brackets are slotted and may be adjusted to meet this dimension. If necessary, adjust the OmniDeck height before securing to the brackets.

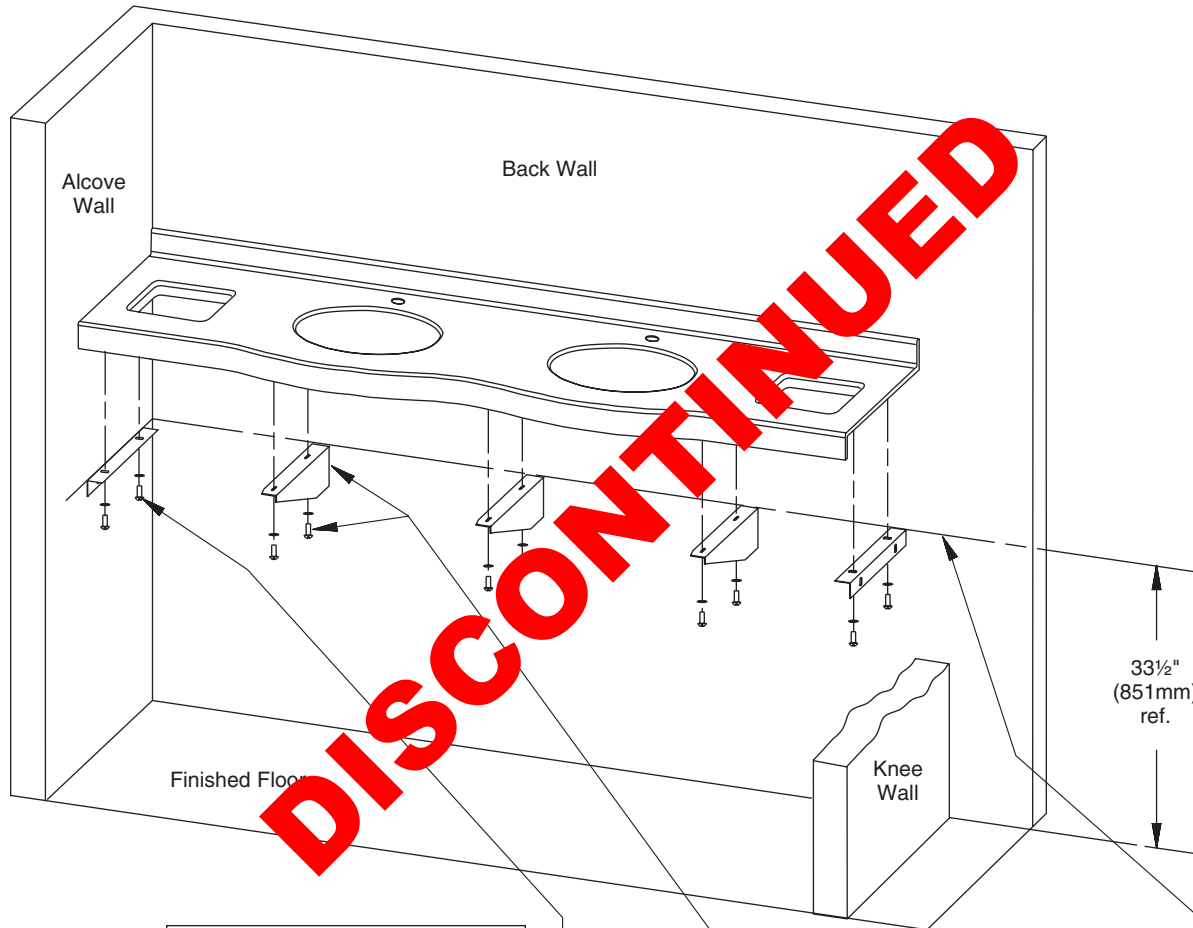

B Secure the angle brackets to the bottom of the OmniDeck with the hardware provided.

A Scribe a level line for the mounting brackets 33 1/2" above the finished floor.

Secure the mounting brackets to the wall with hardware supplied by the installer.

C With help from at least one other person, position the OmniDeck on the mounting brackets and secure the deck with the hardware provided.

- For alcove wall only, secure the angle bracket to the alcove wall after installation of the OmniDeck is complete.

3 Supplies, Drain and P-trap

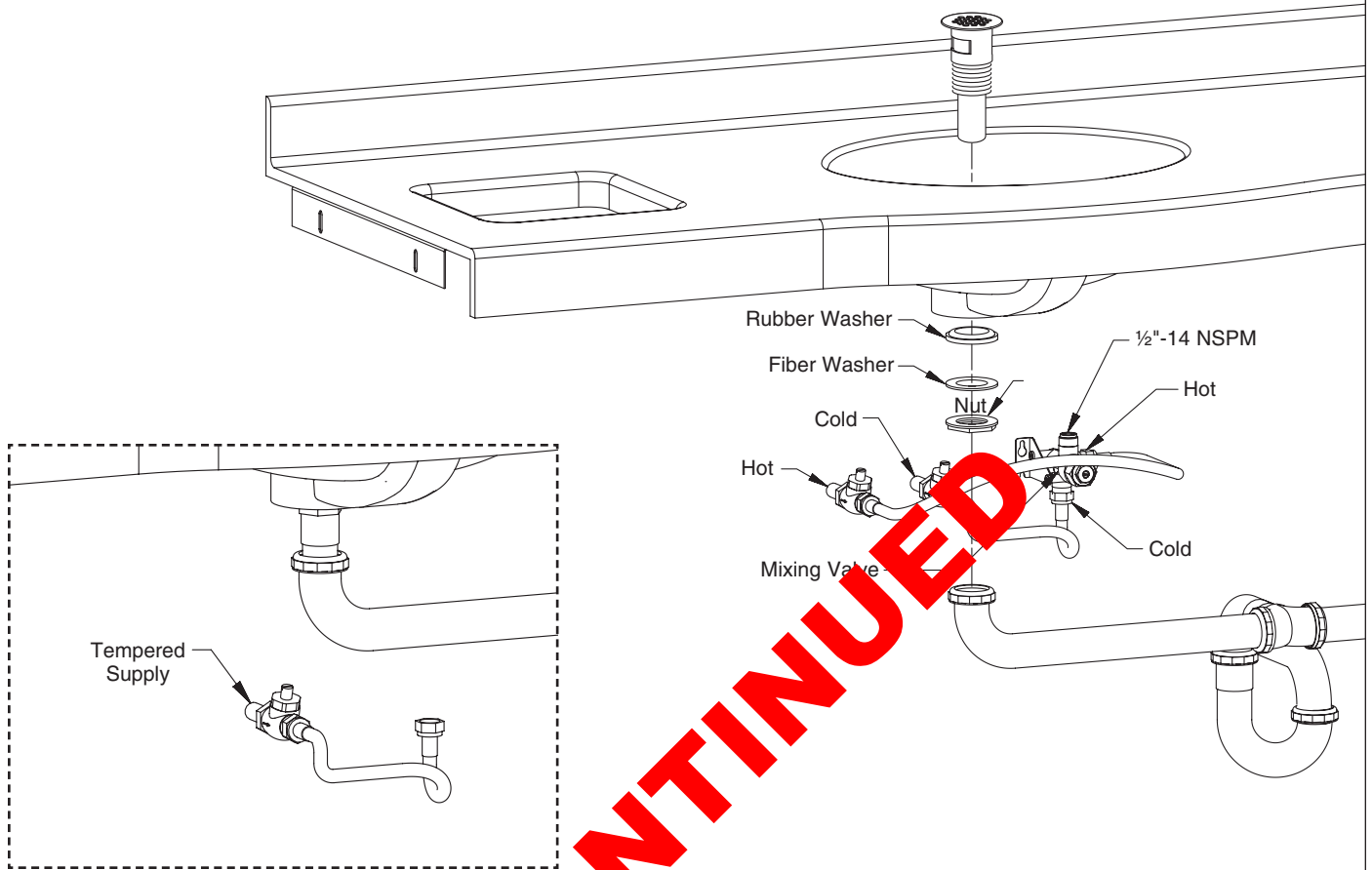

4 Trap Cover Installation

- Standard trap cover is shown.
Optional V2 trap cover is similar.

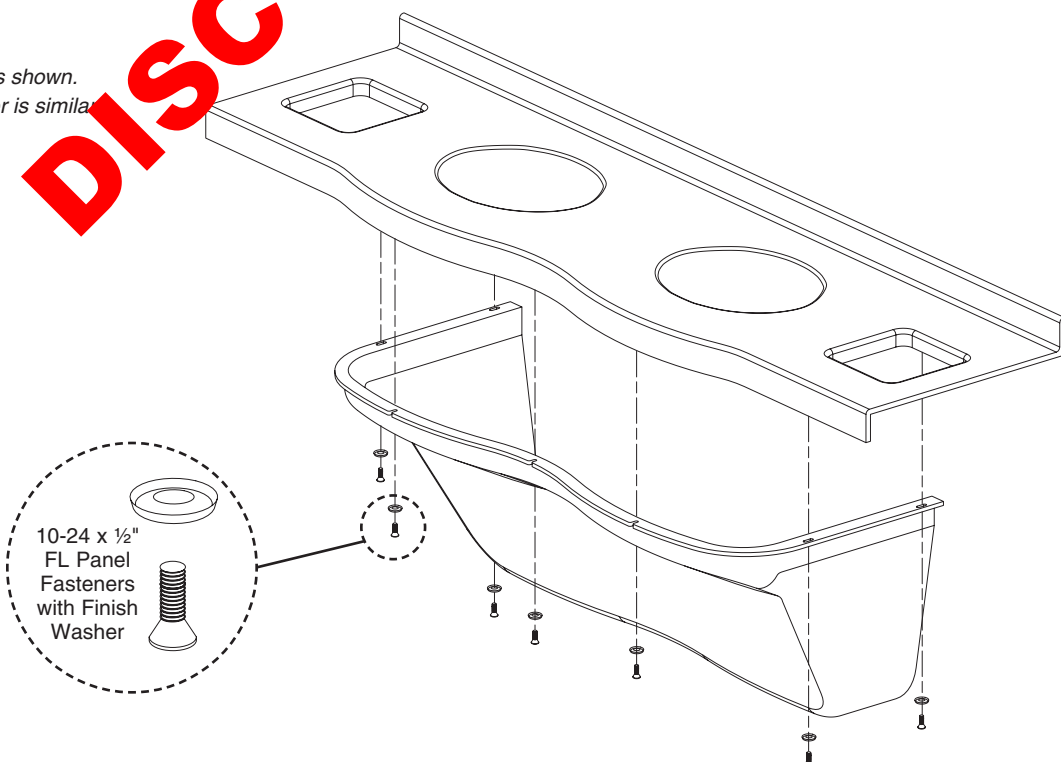

DISCONTINUED

Cleaning and Maintenance for Terreon®

Material Description: Terreon is an NAHB-certified densified solid surface material composed of polyester resin and is resistant to chemicals, stains, burns and impact. Surface damage can be easily repaired with everyday cleansers or fine grit abrasives.

Routine Cleaning: Clean daily or as often as conditions require using a standard commercial or household cleaner such as Formula 409® or Windex®.

Stubborn Stains: Remove tough stains with Ajax®, Comet®, or Soft-Scrub® and a green Scotch-Brite® pad or lightly sand in a circular motion with 240 grit wet/dry sandpaper. The finish can be renewed with a maroon Scotch-Brite pad.

Special Situations for Terreon Material

Scratches: Remove scratches with a green Scotch-Brite pad. The finish can then be renewed with a maroon Scotch-Brite pad, followed by a white Scotch-Brite pad or 30-micron sandpaper.

Hard Water Deposits: Remove hard water deposits with a mild solution of vinegar and water. Always rinse the unit thoroughly after cleaning.

Restoring the surface: Use Hope's® Solid Surface cleaner and polish to refresh and protect the Terreon Solid Surface material. Bradley recommends additional care and maintenance for the darker colored Terreon. For complete instructions on this additional maintenance, visit bradleycorp.com.

⚠ Do not use strong acid or alkaline chemicals and cleansers to clean Terreon. If these chemicals come in contact with the surface, wipe them off immediately and rinse with soap and water. Avoid contact with harsh chemicals such as paint remover, bleach, acetone, etc. Avoid contact with heat and objects.

Repair Kits: Terreon repair kits are available. Contact your Bradley representative or distributor for part numbers and pricing. Repair kits are made to order and have a shelf life of 30 days.

Terreon® is a unique, cast solid surface material. Aggregate flow and distribution as well as shades of color can vary from product to product creating natural characteristics.

Cleaning and Maintenance for Stainless Steel

Material Description: Stainless steel is extremely durable, and maintenance is simple and inexpensive. Proper care, particularly under corrosive conditions, is essential. Always start with the simplest solution and work your way toward the more complicated.

Routine cleaning: Daily or as often as needed use a solution of warm water and soap, detergent, or ammonia. Apply the cleaning solution per the manufacturer's instructions and always use a soft cloth or sponge to avoid damaging the finish.

Stubborn Stains: To remove stains from stainless steel use a stainless steel cleaner and polish such as Ball® stainless steel cleaner or a soft abrasive. Always follow the manufacturer's instructions and apply in the same direction as the polish lines.

⚠ Never use ordinary steel wool or steel brushes on stainless steel. Always use stainless steel wool or stainless steel brushes.

Fingerprints and Smears: To remove fingerprints or smears use a high quality stainless steel cleaner and polish in accordance with the manufacturer's instructions. Many of these products leave a protective coating that helps prevent future smears and fingerprints.

Grease and Oil: To remove grease and oil use a quality commercial detergent or caustic cleaner. Apply in accordance to the manufacturer's instructions and in the direction of the polish lines.

Precautions: Avoid prolonged contact with chlorides (bleaches, salts), bromides (sanitizing agents), thiocyanates (pesticides, photography chemicals, and some foods), and iodides on stainless steel equipment, especially if acid conditions exist.

⚠ Do not permit salty solutions to evaporate and dry on stainless steel.

The appearance of rust streaks on stainless steel leads to the belief that the stainless steel is rusting. Look for the actual source of the rust in some iron or steel particles which may be touching, but not actually a part of the stainless steel structure.

Strongly acidic or caustic cleaners may attack the steel causing a reddish film to appear. The use of these cleaners should be avoided.

Brand Names

Use of brand names is intended only to indicate a type of cleaner. This does not constitute an endorsement, nor does the omission of any brand name cleaner imply inadequacy. Many products named are regional in distribution, and can be found in local supermarkets, department and hardware stores, or through your cleaning service. It is emphasized that all products should be used in strict accordance with package instructions.

Troubleshooting – Vernatherm™ Thermostatic Mixing Valve: Part no. S01-524



Before attempting to troubleshoot the valve or disassemble the components, check for the following conditions:

- If stop/check valves are used, make sure that they are fully open.
- Make sure that the hot and cold inlet pipes are connected properly, and that there are no cross-connections or leaking stop/check valves.
- Make sure water heater output is at least 20° F above the set temperature.



Close shut-off valves prior to disassembly and reopen the valves after inspection and repair is complete.

Repair Kit S65-259

Item	Qty.	Description
5	1	Thermostat
7	1	O-ring
8	1	O-ring

Tempered Line Adapter Option: Part no. S39-685

(replaces S01-524 if tempered line is used)

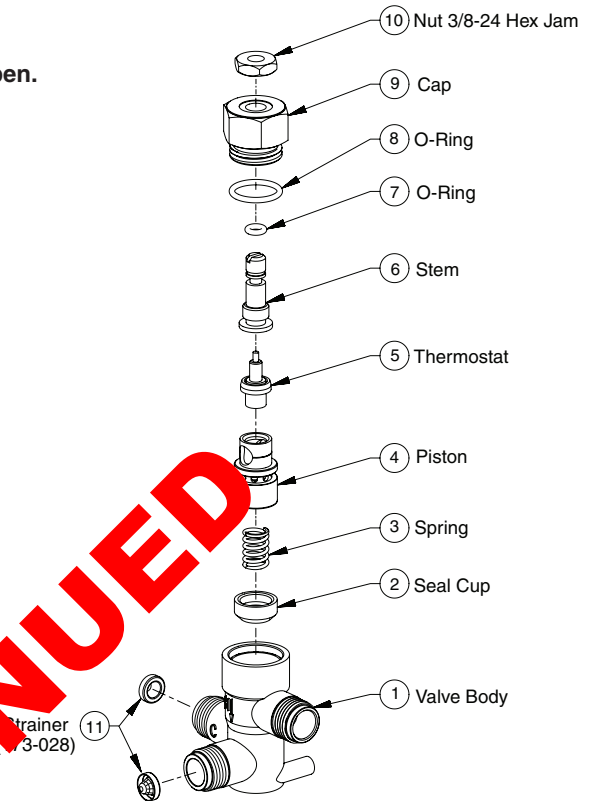
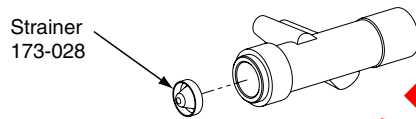

DISCONTINUED

Problem	Cause	Solution
External leaks in the system.	<i>O-rings have been damaged.</i>	Replace O-rings. Contact your Bradley representative to order Repair Kit no. S65-259.
Improper water temperature or temperature fluctuation.	<i>Thermostat is slowly failing or not working at all.</i>	Check thermostat for proper operation: 1. At room temperature (80° F or less) remove the cap and thermostat. 2. Place the thermostat into a container with 115° F water. The push rod should pop out of the thermostat approximately 1/10". If push rod does not pop out, replace the thermostat. Contact your Bradley representative to order Repair Kit no. S65-259.
	<i>Valve temperature is not properly set</i>	Adjust the temperature using a blade screwdriver: Turn the adjustment stem counterclockwise to increase the temperature or clockwise to decrease the temperature.
Limited water flow.	<i>Dirt and debris have built up in the valve or strainer.</i>	1. Ensure hot and cold supplies are connected to the mixing valve and that they have sufficient water flow. 2. Remove and clean the strainer. If it needs to be replaced, Contact your Bradley representative to order Bradley part no. 173-028. 3. Check the piston for smooth movement: A. Remove the valve's cap and thermostat. B. Push down on the piston; if the piston does not move freely, clean it as outlined below: <ul style="list-style-type: none"> • Remove the thermostat. Lift the piston out with a needle-nose pliers and remove the spring. • Any brass and stainless steel cleaner may be used. If a suitable cleaner is insufficient to remove debris, use a 400-grit sandpaper to polish and hone the piston and valve body). • Snap the spring into the piston (it will detent); reassemble into the valve body. Retest the piston. C. If, after a thorough cleaning, the piston does not move freely, the piston must be replaced. Contact your Bradley representative to order Repair Kit no. S65-259.