

Pos-I-Pak valves

Individual Showers — Concealed
Used from January 1978 to March 1983.
Components no longer available.
Single Tempered Supply Uses Washer 142-027
And Valve Unit S27-157.

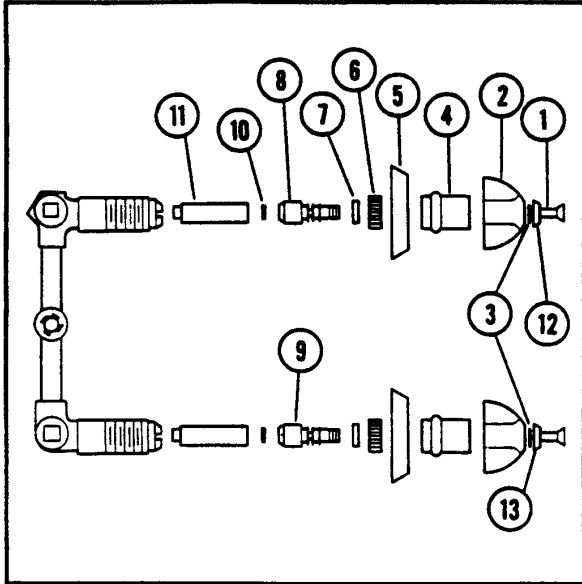

PARTS LIST		
No.	Part	Description
1	160-261	Screw
2	128-049	Handle
3	142-002BL	Washer
4	169-743	Sleeve
5	169-742	Escutcheon
6	169-650	Cap
7	125-001BC	O-Ring 13/16 x 5/8
8	S27-157	Valve Unit (Includes 169-748 & 169-746)
9	S27-157A	Valve Unit (Includes 169-748 & 169-746)
10	125-001BY	"O" - Ring 1/2 x 3/8
11	169-741	Waterway Sleeve
12	142-027A	Washer — Cold (Blue)
13	142-027B	Washer — Hot (Red)

HOT & COLD VALVES
Individual Showers — Concealed
Used from March 1983 To Present.
Single Tempered Supply Uses Washer 142-027.

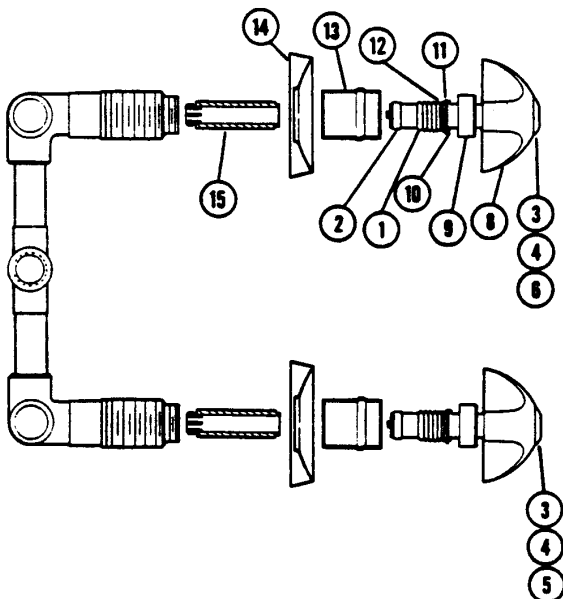

PARTS LIST		
No.	Part	Description
1	119-052	Valve Stem
2	S21-021	Extension
3	142-002BL	Insert Washer
4	160-145	Screw
5	142-027B	Red Washer
6	142-027A	Blue Washer
8	128-060	Handle
9	121-019	Bonnet
10	125-001BC	"O" - Ring
11	124-001BD	Fiber Washer
12	142-002BF	Brass Washer
13	113-430	Sleeve
14	150-110	Escutcheon
15	117-034	Seat