

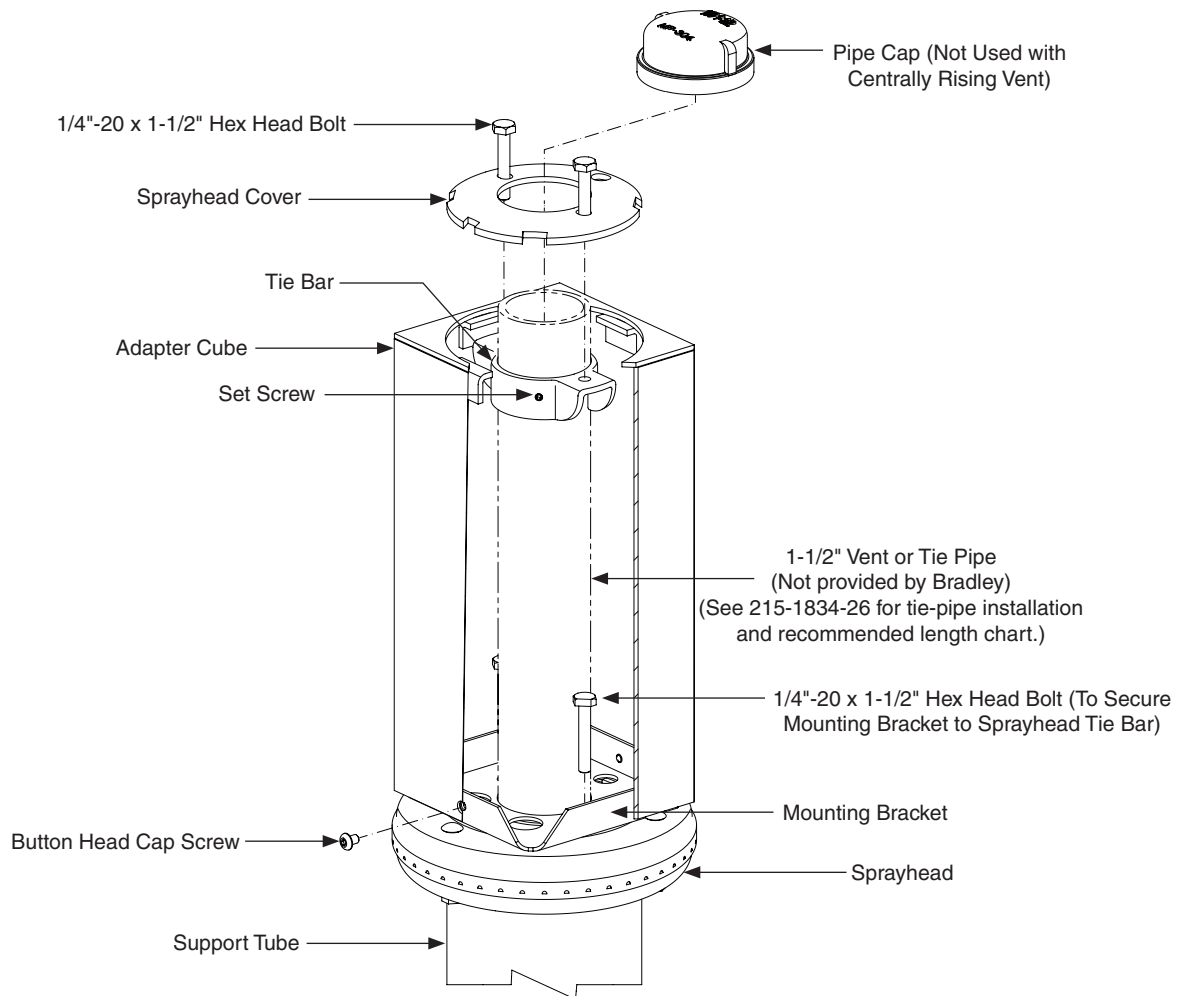

# Soap Dispenser Adapter WF2500, WF2600, WF2700, WF2800, WF3200, TDB3100 Series

P.O. Box 309 • Menomonee Falls, WI 53052-0309 • 1 800 BRADLEY • 262 251 6000 • bradleycorp.com

## Soap Dispenser Adapter



**A** Install tie pipe/vent pipe (see note), support tube, sprayhead tie bar and sprayhead per instructions included with washfountain.



*Drain must be connected with 2" nominal schedule 40 iron pipe (minimum) to provide lower support for this installation.*

**B** Install mounting bracket with (2) 1/4"-20 x 1-1/2" hex head screws.

**C** Position soap dispenser adapter tie bar approximately 1/2" below top of adapter. Secure tie bar to pipe with (3) set screws.

**D** Assemble soap dispenser to adapter.

**E** Position adapter on mounting bracket and fasten with (2) #10-24 button head cap screws.

**F** Place cover on adapter and fasten with (2) 1/4"-20 x 1-1/2" hex head screws.

**G** Install pipe cap on tie pipe (not required for units with centrally rising vent).