

Installation

S19-435EFW

Angled Hand-Held Eye/Face Body Wash Drench Hose with Hose Holder

Table of Contents

Pre-Installation Information	2
Installation Instructions	2
Components and Parts List	3

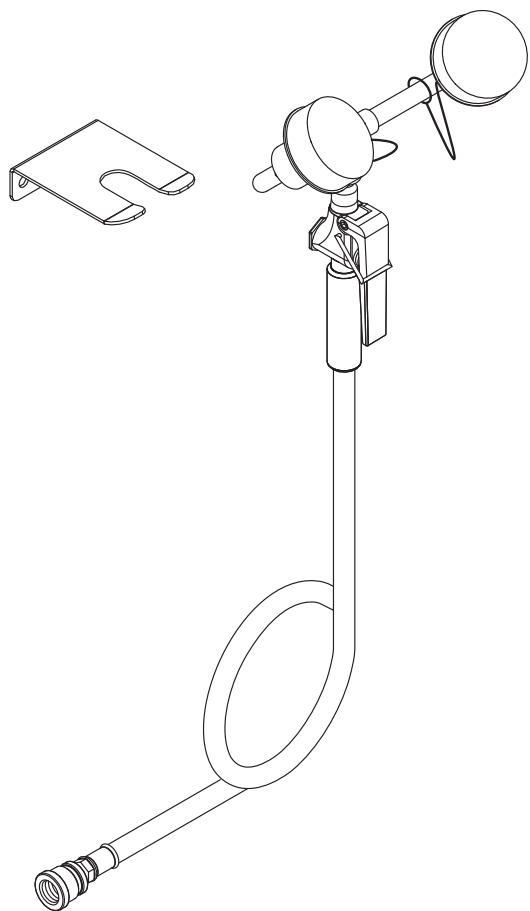

⚠ WARNING ⚠

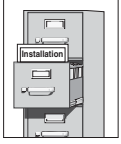

Read this installation manual completely to ensure proper installation, then file it with the owner or maintenance department. Compliance and conformity to drain requirements and other local codes and ordinances is the responsibility of the installer.



Separate parts from packaging and make sure all parts are accounted for before discarding any packaging material. If any parts are missing, do not begin installation until you obtain the missing parts.

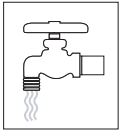

Flush the water supply lines before beginning installation and after installation is complete. Test the unit for leaks and adequate water flow. Main water supply to the eyewash should be "ON" at all times. Provisions shall be made to prevent unauthorized shutoff.



The ANSI Z358.1 standard requires an uninterrupted supply of flushing fluid at a minimum 30 PSI (0.21 MPa) flowing pressure. Flushing fluid should be tepid per ANSI Z358.1.



The inspection and testing results of this equipment should be recorded weekly to verify proper operation. This equipment should be inspected annually to ensure compliance with ANSI Z358.1.



Workers who may come in contact with potentially hazardous materials should be trained regarding the placement and proper operation of emergency equipment per ANSI Z358.1.



For questions regarding the operation or installation of this product, visit www.bradleycorp.com or call 800.BRADLEY (800.272.3539).

Product warranties and service parts information may also be found under "Products" on our web site at bradleycorp.com.

Installation

Supplies Required:

- Teflon tape and/or pipe sealant
- ½" NPT water supply piping
- #10 screw to mount hose holder (anchor optional)
- Sign-mounting hardware
- Backflow prevention device as required by UPC, IPC and/or local plumbing codes

Step 1: Mount the Hose

1. Rough in ½" NPT supply piping (by installer) from the wall where the hose holder will be mounted.
2. Mount the hose holder to the wall with a #10 screw (supplied by installer). Install wall anchor if desired.

Step 2: Connect water supply

NOTE: Apply pipe sealant (supplied by installer) to all male threaded pipe joints.

1. Connect the end of the drench hose to the ½" NPT water supply.
2. Mount the safety sign to the wall using the sign-mounting hardware (supplied by installer).
3. Open the water supply line. Test for leaks and adequate water flow.

Assembly of Components and Parts List

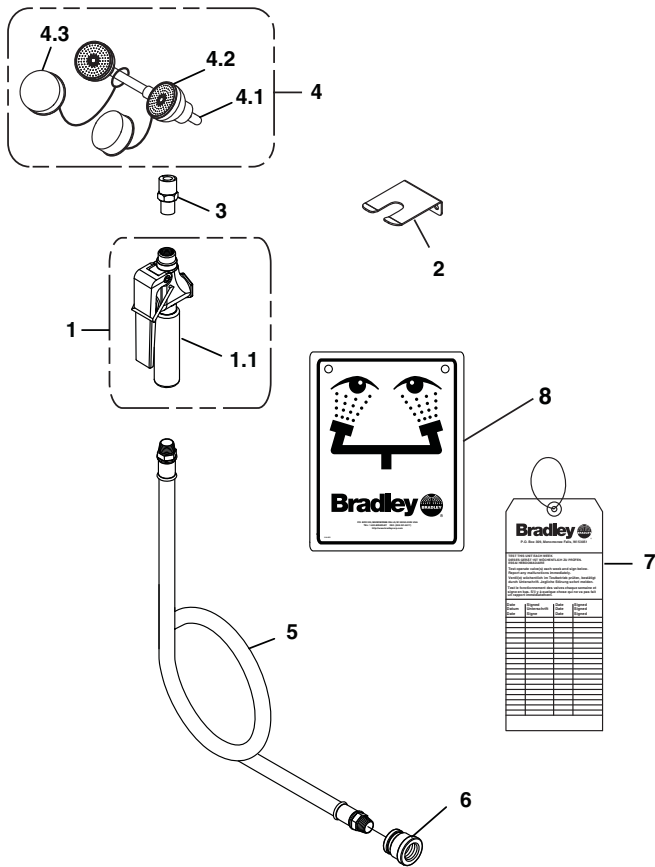

Item	Part No.	Qty.	Description
1	S27-265	1	Valve Assembly with Handle
1.1	269-661	1	Handle only
2	S45-831	1	Hose Holder Prepack
3	153-337	1	Adapter
4	S05-064D	1	EFW Assembly
4.1	S05-091P	1	EFW Yoke Assembly
4.2	S05-135	2	EFW Sprayhead
4.3	S53-063	2	Dust Cover
5	S89-002	1	Yellow Hose, 3/8" x 8'
6	169-059	1	Reducing Coupling 1/2" NPT x 3/8" NPT
7	204-421	1	Emergency Inspection Tag
8	114-051	1	Safety Sign

Hose Holder Installation

Wall Mounting

NOTE: Install the unit so that the top of the sprayhead is 33"-45" (838mm-1142mm) from the finished floor.

