

Aerada™ 1100 Series High Arc Faucets with Infrared Control

Models S53-304, S53-305

- ADA Compliant External Temperature Control
- Reliable Infrared Activation
- Vandal Resistant Cast Brass Spout
- 6-volt DC Lithium Battery Operation (Battery Included)
- 115-volt AC Plug-in Adapter Available (Not Included)
- Chrome Plated Finish
- Easily Serviceable Above-Deck Electronics

Specifications

User Operation

The faucet activates water flow only when the user's hands enter a broad infrared detection zone within the lavatory bowl perimeter. The ADA compliant external temperature control allows the user to manually select the temperature of the water flowing from the faucet. The external temperature control does not require tight grasping and requires less than 5 pounds of pressure to turn. The faucet will turn itself off after hands are removed from the lavatory bowl area, allowing users to dry hands or groom without wasting water.

Component Operation

The Aerada™ 1100 Series High Arc faucets control water by using an electronically powered sensor module to open and close the solenoid valve. The 1100 Series High Arc faucets can be powered by either a single 6-volt DC lithium battery (included) or a 115-volt AC plug-in adapter (not included).

When the hands enter the infrared detection area, the sensor starts water flow by electronically opening the solenoid valve. When hands leave the detection area, the sensor stops water flow by closing the valve. The infrared sensor scans the detection area 4 times per second in standby mode and 6 times per second when a user has been detected. This ensures reliable operation, as well as energy conservation.

Standard Equipment

Infrared Sensor

The sensor module uses a zone-focused infrared transmitting beam, creating a detection area not exceeding the bowl perimeter. The sensor is not affected by varying skin tones or lighting conditions. The sensor's electronics provide positive user identification, eliminating false activations.

Valve

The electronically activated solenoid valve provides reliable performance since there are few moving parts and it's operation is unaffected by most chemicals and minerals found in municipal water supplies. The faucet includes (2) stainless steel supply hoses with check stops to prevent backflow into the supply lines.

Flow Control/Rate

Operating range 20-80 PSI. The flow rate is .5 GPM.



Faucet Body

Chrome-plated, solid cast brass body. Centershank mounting, with optional 4" centerset chrome-plated trim plate available.

Sanitary

No-touch operation reduces water/soap splatter and addresses the public's increasing awareness and concern about communicable diseases.

Vandal Resistant

The sensor module, circuit board and solenoid valve are enclosed in the solid cast brass faucet body. The faucet also features a vandal resistant aerator.

Code Compliance and Certifications

CSA

The 1100 Series High Arc faucets are CSA certified to meet CSA B125 test standards for plumbing fixtures. The faucets are approved for Canadian standards.

UPC

The 1100 Series High Arc Faucets are Uniform Plumbing Code (UPC) certified by the International Association of Plumbing and Mechanical Officials (IAPMO).

ASME A112.18.1

The 1100 Series High Arc Faucets are certified to meet the ASME A112.18.1 standard for plumbing fixture fittings.

ADA Compliance

The sensor module produces a broad detection zone that allows disabled users to easily activate the faucet from either a front or side approach, thereby meeting ADA guidelines provided by ANSI A117-1. The external temperature control does not require tight grasping or rotating, and turns on less than 5 pounds of pressure; therefore complying to ADA guidelines provided by ANSI A117-1.



Bradley 

P.O. Box 309, Menomonee Falls, WI 53052-0309
Phone 1-800-BRADLEY FAX 262-251-5817
<http://www.bradleycorp.com>

Document No. 3047

This information is subject to change without notice.
© 2004 Bradley Corporation
10-13-2005 (2 Pages Total)

Aerada™ 1100 Series High Arc Faucets with Infrared Control

Models S53-304, S53-305

Check Your Surroundings

Certain factors, such as intense direct sunlight, other infrared devices, or other site conditions may interfere with the activation of infrared faucets. Contact your local Bradley representative to discuss any application concerns.

Sample Specification

No-touch infrared faucet shall be (S53-304) Bradley Aerada™ 1100 Series High Arc IR Faucet. The faucet shall be powered by a 6-volt DC lithium battery (included). The infrared sensor will include electronics that provide positive user identification, thereby eliminating false activations. The infrared temperature control will be constructed of solid cast brass and will comply with ADA guidelines. The infrared electronic sensor module will automatically trigger the solenoid valve to control water flow. The sensor module, circuit board and solenoid valve shall be located within the faucet body. The faucet shall include a chrome-plated, solid cast brass body, centershank mounting, .5 GPM aerator and (2) stainless steel flexible supply hoses. The faucet shall be UPC approved and certified to CSA standards.

MODELS – Faucet Only

Part No.	Model/Description
<input type="checkbox"/> S53-304	DC High Arc IR Faucet Ext Temp Control
<input type="checkbox"/> S53-305	AC High Arc IR Faucet Ext Temp Control

OPTIONAL SELECTIONS

Part No.	Model/Description
Plug-in Transformer:	
<input type="checkbox"/> 232-006	Plug-in Adapter, 115-V for AC High Arc Faucet
<input type="checkbox"/> 232-005	Multi-use Transformer for AC High Arc Faucet
4" Cover Plate:	
<input type="checkbox"/> 159-425	4" Chrome Cover Plate for High Arc Faucet
Drain Assembly:	
<input type="checkbox"/> 269-1231	D-ASSY, Drain, Strainer, and Tailpiece

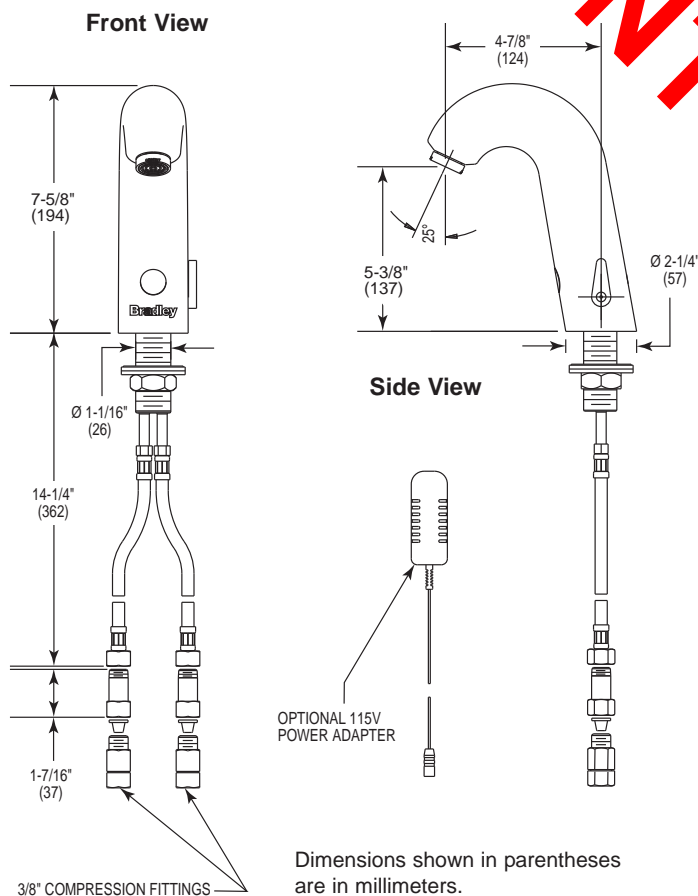

Document No. 3047

This information is subject to change without notice.
10-13-2005 (2 Pages Total)

FA3047.2

Bradley 

P.O. Box 309, Menomonee Falls, WI 53052-0309
Phone 1-800-BRADLEY FAX 262-251-5817
<http://www.bradleycorp.com>