



# 2903-28

## Aerix® Sensor-Operated Warm Air Hand Dryer

☒ Recommended for high to very high traffic areas.

### 2903-280000—Standard

(110–120 volt, 16 amps, 60 Hz - White) **Bradex®**

## Product Materials

**COVER:** ¼" (6 mm) thick one-piece cast iron with white porcelain enameled coating. Cover fixed to the base plate with two vandal-resistant lock screws and lock with special key wrench.

**NOZZLE:** chrome-plated zamak. Nozzle is fixed.

**MOTOR:** universal-type protected by a 4-amp fuse with sealed self-lubricated ball bearings. Aluminum centrifugal turbine with double symmetrical inlet. Fireproof plastic UL 94-V0 scroll fan.

**HEATING ELEMENT:** undulated nicrom with a safety thermostat.

**ELECTRONIC CONTROL:** electronic infrared detection sensor is adjustable (6"–10"). Switch-off delay is two seconds maximum.

☒ Model 2903-28 has a proximity sensor mounted to the cover near the air outlet with a wire clipped to the base. Before completely removing the cover, the wire must be unclipped from the base.

**BASE PLATE:** ⅛" (3 mm) thick aluminum, with four Ø ⅝" (8mm) holes for wall mounting.

## Installation

Verify all rough-in dimensions prior to installation. Hand dryers require a dedicated circuit and must be properly grounded. GFI Circuit protection is recommended. One side of dryer should be mounted to a stud.

## Operation

Place hands 3"–6" below nozzle to activate air flow. Dryer will stop two seconds after hands are removed from air flow.



## Guide Specification

Surface-mounted hand dryer shall have a thick cast iron cover with white porcelain enameled coating and aluminium back base. Hand dryer shall be fitted with a fixed chrome-plated zamak nozzle, infrared electronic control and universal-type motor with resilient mounts and sealed, lubricated ball bearings. Dryer shall operate at 70 dB while delivering 290 CFM of air at 128°F (53°C) and 5,512 LFM velocity during user-controlled drying cycle. The dryer shall have a total power of 1,850 W (2903-28) with a consumption of 16 A (2903-28).

**Overall dimensions:** 10"H x 11⅞"W x 8½"D  
(254mm x 283mm x 216mm).

**Weight:** 23.35 lb (10.6 kg).

Orders composed of products indicated as **Bradex®** will be available to ship in three days after receipt of order at the factory. There is no pricing penalty for this service from Bradley.

Page 1 of 2  
4/22/2025  
This information is subject to change without notice.  
Bradley\_HandDryer\_2903-2800

© 2025 Bradley  
P.O. Box 309, Menomonee Falls, WI 53052-0309  
800 BRADLEY (800 272 3539) +1 262 251 6000  
bradleycorp.com



A WATTS Brand

2903-28

Aerix® Sensor-Operated Warm Air Hand Dryer

## Product Specifications

Voltage:	2903-28 — 110–120 V	Consumption:	2903-28 — 16 A
Motor:	1/3 HP (250W)	RPM:	5,500
Nominal power:	2903-28 — 1,850 W (2.5 Hp)	Heating element:	1,600 W (2.15 Hp)
Effective airflow:	203 CFM	Nominal airflow:	290 CFM
Noise level at 79":	70 dB	Airspeed:	5,512 LFM
Frequency:	50/60 Hz	Insulation:	Grounding required
Temperature (at 4" distance / 70°F):	128°F (53°C)	Certificates:	2903-28 — UL 499/CSA C22.2 EMC/CE GOST
Drying time:	29 seconds	Mounting:	Surface

## Dimensions

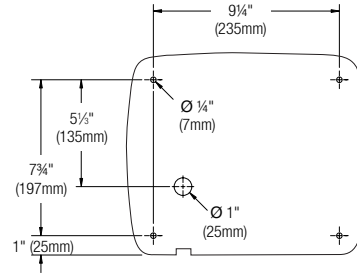
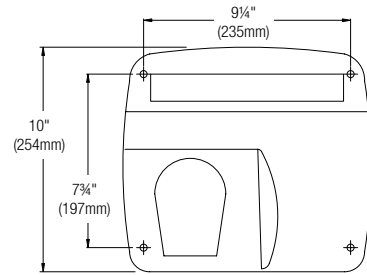

☒ All dimensions  $\pm$  4%.

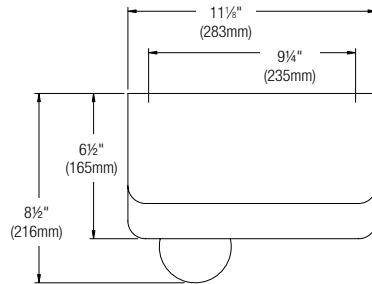

Orders composed of products indicated as **Bradex®** will be available to ship in three days after receipt of order at the factory. There is no pricing penalty for this service from Bradley.

Page 2 of 2  
This information is subject to change without notice.  
Bradley\_HandDryer\_2903-2800

4/22/2025

© 2025 Bradley  
P.O. Box 309, Menomonee Falls, WI 53052-0309  
800 BRADLEY (800 272 3539) +1 262 251 6000  
bradleycorp.com